



CJ19 Contactor for Power Factor Correction

1. General

- 1.1 Electric ratings: AC50/60Hz, up to 400V;
- 1.2 Standard: IEC/EN 60947-4-1



2. Type designation

CJ 19 □ □

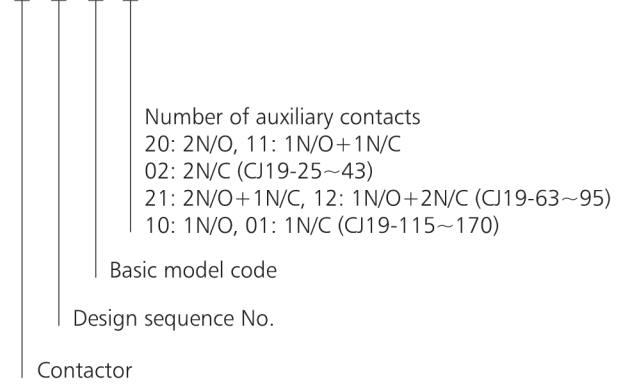

3. Normal operation conditions

- 3.1 Ambient temperature: $-5^{\circ}\text{C} \sim +40^{\circ}\text{C}$, the average during 24 hours should not exceed $+35^{\circ}\text{C}$;
- 3.2 Altitude: $\leq 2000\text{m}$;
- 3.3 Atmosphere conditions: At mounting site, relative humidity not exceed 50% at the max temperature of $+40^{\circ}\text{C}$, higher relative humidity is allowable under lower temperature. For example, RH could be 90% at $+20^{\circ}\text{C}$, special measures should be taken to occurrence of dews;
- 3.4 Pollution degree: 3
- 3.5 Installation category: III
- 3.6 Installation conditions : the inclination between installation plane and vertical plane is within $\pm 5^{\circ}$
- 3.7 Impact and shake: the products should locate in the places where there are no obvious impact and shake.

4. Technical data

Item	CJ19-25	CJ19-32	CJ19-43	CJ19-63	CJ19-95	CJ19-115	CJ19-150	CJ19-170
Controllable capacitor 220V Capacity	6	9	10	15	28.8(240V)	34.5(240V)	46(240V)	52(240V)
380V	12	18	20	30	50(400V)	60(400V)	80(400V)	90(400V)
Rated Isolation Voltage U_i V	500					690		
Rated Operational Voltage U_e V	220/240, 380/400							
Conventional thermal current I_{th} A	25	32	43	63	95	200	200	275
Rated Operational current I_e A (380V)	17	23	29	43	72.2 (400V)	87 (400V)	115 (400V)	130 (400V)
Restrained surge capacity	20 I_e							
Controlled power voltage	110 127 220 380							
Auxiliary contact	AC-15: 360VA DC-13: 33W I_{th} :10A							
Operating Frequency cycles/h	120							
Electrical durability 10^4	10					2		
Mechanical durability 10^4	100					300		

Contactors

5. Overall and mounting dimensions (mm)

CJ19-25~43

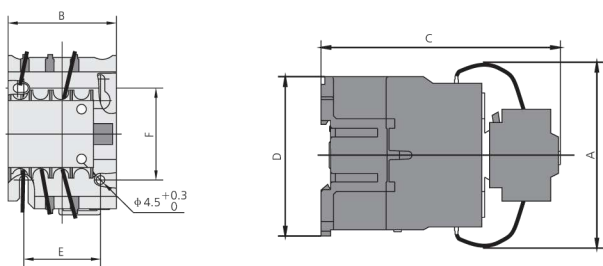

CJ19-63~95

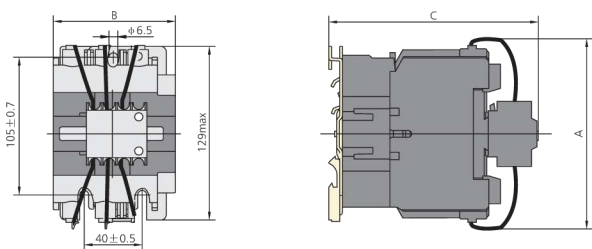

CJ19-115~170

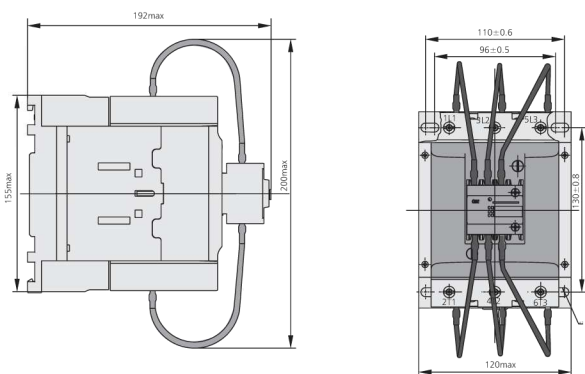

Model	Amax	Bmax	Cmax	Dmax	E	F	Note
CJ19-25	80	47	124	76	34/35	50/60	Not only fixed by screws but also could be fixed with 35mm din rail
CJ19-32	90	58	132	86	40	48	
CJ19-43	90	58	136	86	40	48	
CJ19-63	132	79	150	-	-	-	Not only fixed by screws but also could be fixed with 35mm and 75mm din rail
CJ19-95	135	87	158	-	-	-	
CJ19-115	200	120	192	155			Not only fixed by screws but also could be fixed with two 35mm din rail
CJ19-150	200	120	192	155			
CJ19-170	200	120	192	155			

6. Wiring and installation

- 6.1 The connection terminals are protected through insulation cover, which is reliable and secure for installation and operation;
- 6.2 For CJ19-25~43, screws are available for installation, as well as the DIN rail;
for CJ19-63~95, 35mm or 75mm standard rail are available for installation.
for CJ19-115~170, screws are available for installation, as well as two 35mm DIN rail.