



— OPEN·HONEST·CONSCIENTIOUS·FAST·PROMISE —

Open Group Holding Ltd

CIRCUIT BREAKER SERIES

Open Group Holding Ltd

Address: OPEN Building, Liunan Industrial Zone, Xiangyang Town, Yueqing
City, Zhejiang Province China

Post Code: 325619

TEL: 0086-577-6262 1999

FAX: 0086-577-6273 2105

E-mail: sales@opengroup.cc global-sales@opengroup.cc
salesdirector@opengroup.cc





Based on credit win by quality

- <http://www.opengroup.cc/>
- <http://cn-opengroup.com/>
- <http://mcb.en.alibaba.com/>
- <http://open.en.alibaba.com/>
- <http://www.open-electric.com/>
- <http://www.opengroup-energy.com/>
- <http://www.opengroup-energy.com/cn/>
- <http://www.ecvv.com/company/Open7815/index.html>



Company Profile

OPEN GROUP HOLDING LTD. is located in Liushi, Wenzhou, Zhejiang Province, China. It faces the 104 National Highway that run-through Zhemin Economic Zone, close to Qili Harbor and Wenzhou Airport on the south, close to the scenic spot Yandang Mountain on the north.

Quality assurance and customer satisfaction lead Open Group's top belief. OPEN GROUP HOLDING LTD. is one of the most professional manufacturers producing low-voltage and high-voltage electrical products, power equipment, cables & wires, etc. Through last 10 years' development, OPEN GROUP HOLDING LTD. has grown up as one of the biggest group companies in China, and the products range includes lightings, and lamp. We have over fifty member factories for the products above, and our products include 1,500 series and more than 15,000 industrial components.

We have precious experiences in exporting our products to the Southeast Asian, Australian, European and the American markets. Our products are well-known greatly due to high quality and reasonable price. After more than 10 years' promotion and service in the world, our products are enjoying a great share in the international market.

To present our customer more considerate service, OPEN GROUP HOLDING LTD. has modernized our production equipment, enhanced production technology and management mode. To form designing, producing, quality checking, selling as an organic whole, from quality control of the input of the raw materials and feedback of the after-sale service, etc., we have introduced TQM and other advanced producing methods to ensure the interest of our customers.

The 21st century is the era of the knowledge economy, full of the fierce competitions of technology and managing mode, but meanwhile, we can tell that there are also so many opportunities to get mutual benefits. Welcome domestic and international friends to cooperate cordially with OPEN GROUP HOLDING LTD. We believe with our best efforts, we can create the prosperity and development for both of our business.





Production & Device

Professional, the achievement of excellence quality……
The Open Group Holdings LTD. attached great importance to the improvement of the production equipment and update, the introduction of foreign advanced production and testing equipment, strict production site management, capable of production personnel, make product quality.
In introducing new technology, new technology, new material continuously innovation, every new technology, new product of successful involve Europe this tireless hard crystallization.





Market

Our company positively push the brand marketing, service marketing, advocate honest running. Supply the high quality and reasonable prices products and over value service to our customers. We calmly deal with global economic intergration, and participate in international competition better, today, intensive marketing network have covered all provinces, cities, and exported to the middle east and other countries and regions. The long-term and stable cooperation and common development makes the network to have very strong cohesion and stability; and perfect sale and after-sales service also makes the network to improve competitiveness continuously.

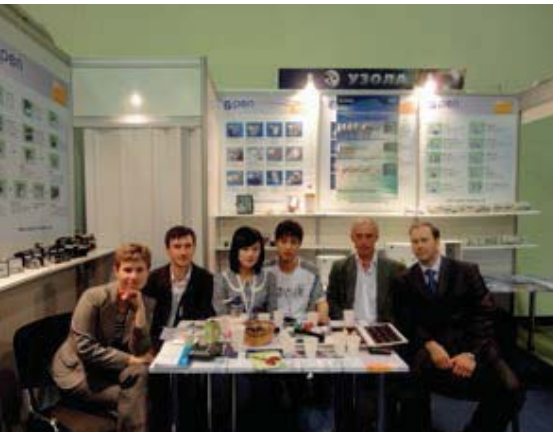

Enterprise Culture

- Open Team
 - Open • Honest • Conscientious • Fast • Promise
- Open Mission
 - Create more value, pass our love and wealth to relatives, clients, society.
- Open Faith
 - Every dream can come true ! eveything is possible in the world !
- Open Prospect
 - To be an enterprise developing continuously for 80 years.
- Open Value
 - Customer first: custmer is the source of food and clothing.
 - Team cooperation: Profit and risk sharing, to be ordinary people and do ordinary work.
 - Embrace Change: Welcome change, dares to innovate.
 - Honesty: Honest and upright, do what we say.
 - Passion: Optimistic, never give up.
 - Dedication spirit: Professional and persistent, keep moving.



Contents

02	DZ47-63 (Old)Mini Circuit Breaker
03	DZ47-63(New) Mini Circuit Breaker
04	OB1-63 Mini Circuit Breaker
05	OB16-63 Mini Circuit Breaker
06	OB8-63 Mini Circuit Breaker
07	OB8-100 Mini Circuit Breaker
08	SL7-DC Mini Circuit Breaker
09	OH1-100 Main Switch
10	LDG-100 Isolator
11	Circuit Breaker Accessories
12	DZ30 DPN
13	OL2-63 Series RCCB
14	OL7 Series RCCB
15	OL8-63 RCCB
16	OB7L-32 series RCBO
17	OBL16-63 RCCB
18	OBL16-100 RCCB
19	OBL1-63 I RCCB
20	OBL1-63 II RCCB
21	OBL1-63 III RCCB
22	DZ30F1-32L RCBO
23	DZ30LE Series RCBO
24	DZ47LE Series RCBO
25	OB8L-40 Series RCBO
26	OB8LE-40 Series RCBO
27	OL11-32 Series RCBO
28	OL16-32 Series RCBO
29	JVB16 Bell
30	BT8-8 Bell Transformer
31	BT16-8 Bell Transformer
32	DZ108(3VE) Moulded Case Circuit Breaker
34	DZ208(3VU) Moulded Case Circuit Breaker
38	DZ518(GV2)
42	DZ518(GV3) Moulded Case Circuit Breaker
43	OM1 Moulded Case Circuit Breaker
51	OM3 Moulded Case Circuit Breaker
63	OM8 Moulded Case Circuit Breaker
66	OW18 Inteuigent Frame-Type-Universal Breaker

DZ47-63(Old) Mini Circuit Breaker



Application

The product is mainly used in AC50/60HZ single-pole 230V or two, three, four-poles 400V circuit for overload and short-circuit protection as well as for infrequent on-and-off switching electric equipment and lighting circuit under normal condition. It can be used in lighting and electric motor distribution system. It is characterized with novel structure, light weight, reliable and excellent performance, high breaking capacity. It is conformity with GB10963, IEC 60898 standard.

Main Technical Parameters

Type	DZ47-63 MCB
Number of poles	1P、2P、3P、4P
Rated Current(In)	1, 2, 3, 4, 6, 10, 16, 20, 25, 32, 40, 50, 63A
Rated Voltage(Un)	AC 230(240)/400(415)V
Rated frequency	50(60)Hz
Curve	B、C、D
Short-circuit breaking capacity(Icn)	6000A
Magnetic releases operate	B curve: between 3 and 5 In C curve: between 5 and 10 In D curve: between 10 and 14 In
Endurance	≥ 4000
Terminal protection	IP20

Construction Feature

The pass electric current characteristic of circuit breaker can not be changed with outside mechanical tool ;The accessory which made by ferrous metal should have proper anti-rusting measure; The operating organization must be flexible and reliable, and should have freed function to take off and deduct; the Operate part can not be taken down from the shell outer of products, the shell of product can not influence the operating organization to work.

Product's Advantage

- 1.Our products have the guarantee period of 36 calendar months, that is a high quality and reliability;
- 2.Our products have an excellent ratio between price and quality, you can possess them by competitive price and high quality;
- 3.The fast and flexible production form aim at the customer require;
- 4.The deliveries exactly in accordance with customer orders
- 5.The fast transportation.
- 6.Wide in variety, entire in specifications, has high short-circuit breaking capacity, can reach 6KA , it is aesthetic in appearance to design and convenient to install.

Overall and Mounting Dimensions

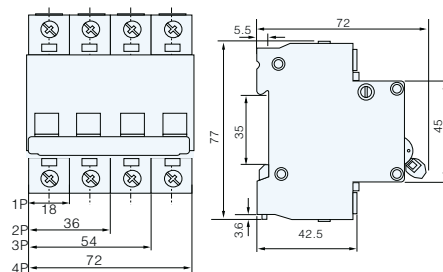

DZ47-63(New) Mini Circuit Breaker



Application

DZ47-63(New) Protection and control of circuit against overload and short circuit, In building installation—such as houses, offices, commercial complex, motor system(D curve) and industrial installation—for switching ,control, protection and regulation of electrical circuits. Also in switchgear panels, railway and marine application.

Main Technical Parameters

Type	DZ47-63 MCB
Number of poles	1P、2P、3P、4P
Rated Current(In)	1, 2, 3, 4, 6, 10, 16, 20, 25, 32, 40, 50, 63A
Rated Voltage(Un)	AC 230(240)/400(415)V
Rated frequency	50(60)Hz
Curve	B、C、D
Short-circuit breaking capacity(Icn)	6000A
Magnetic releases operate	B curve: between 3 and 5 In C curve: between 5 and 10 In D curve: between 10 and 14 In
Endurance	≥ 4000
Terminal protection	IP20

Construction Feature

The pass electric current characteristic of circuit breaker can not be changed with outside mechanical tool ; The accessory which made by ferrous metal should have proper anti-rusting measure; The operating organization must be flexible and reliable, and should have freed function to take off and deduct; the Operate part can not be taken down from the shell outer of products, the shell of product can not influence the operating organization to work.

Product's Advantage

- 1.Our products have the guarantee period of 36 calendar months, that is a high quality and reliability;
- 2.Our products have an excellent ratio between price and quality, you can possess them by competitive price and high quality;
- 3.The fast and flexible production form aim at the customer require;
- 4.The deliveries exactly in accordance with customer orders
- 5.The fast transportation.
- 6.Wide in variety, entire in specifications, has high short-circuit breaking capacity, can reach 6KA , it is aesthetic in appearance to design and convenient to install.

Overall and Mounting Dimensions

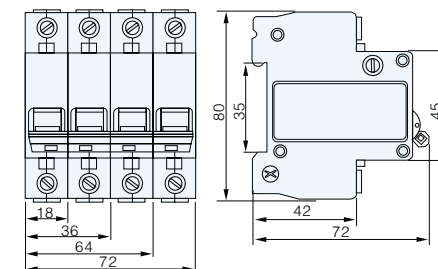

OB1-63 Mini Circuit Breaker



Application

Protection and control of circuit against overload and short circuit, In building installation—such as houses, offices, commercial complex, motor system (D curve) and industrial installation—for switching, control, protection and regulation of electrical circuits. Also in switchgear panels, railway and marine application.

Main Technical Parameters

Type	OB1-63 MCB
Number of poles	1P、2P、3P、4P
Rated Current(In)	1, 2, 3, 4, 6, 10, 16, 20, 25, 32, 40, 50, 63A
Rated Voltage(Un)	AC 230(240)/400(415)V
Rated frequency	50(60)Hz
Curve	B、C、D
Short-circuit breaking capacity(Icn)	6000A
Magnetic releases operate	B curve: between 3 and 5 In C curve: between 5 and 10 In D curve: between 10 and 14 In
Endurance	≥ 4000
Terminal protection	IP20

Construction Features

The pass electric current characteristic of circuit breaker can not be changed with outside mechanical tool; The accessory which made by ferrous metal should have proper antirusting measure; The operating organization must be flexible and reliable, and should have freed function to take off and deduct; Operate part can not be taken down from the shell outer of products, The shell of product can not influence the operating organization to work.

Product's Advantage

1. Our products have the guarantee period of 36 calendar months, that is a high quality and reliability;
2. Our products have an excellent ratio between price and quality, you can possess them by competitive price and high quality;
3. The fast and flexible production form aim at the customer require;
4. The deliveries exactly in accordance with customer orders
5. The fast transportation.
6. Wide in variety, entire in specifications, has high short-circuit breaking capacity, can reach 10KA, it is aesthetic in appearance to design and convenient to install.

Overall and Mounting Dimensions

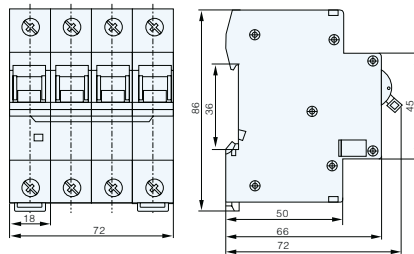

OB16-63 Mini Circuit Breaker



Application

The product is applicable to circuit with rated voltage up to 400V AC, rated frequency 50/60Hz and rated current up to 63A for protection and control of circuit against overload and short circuit in commercial, household and electric equipment installation. The product is suitable for non-frequently making and breaking operation. The product, free of maintenance, can be operated by non-professionals.

Main Technical Parameters

Type	OB16-63 MCB
Number of poles	1P、1P+N、2P、3P、3P+N、4P
Rated Current(In)	1, 2, 3, 4, 6, 10, 16, 20, 25, 32, 40, 50, 63A
Rated Voltage(Un)	AC 230(240)/400(415)V
Rated frequency	50(60)Hz
Curve	B、C、D
Short-circuit breaking capacity(Icn)	10000A (10kA)
Magnetic releases operate	B curve: between 3 and 5 In C curve: between 5 and 10 In D curve: between 10 and 20 In
Endurance	≥ 4000
Terminal protection	IP20

Construction Features

The pass electric current characteristic of circuit breaker can not be changed with outside mechanical tool; The accessory which made by ferrous metal should have proper antirusting measure; The operating organization must be flexible and reliable, and should have freed function to take off and deduct; Operate part can not be taken down from the shell outer of products; the shell of product can not influence the operating organization to work.

Product's Advantage

1. Our products have the guarantee period of 36 calendar months, that is a high quality and reliability;
2. Our products have an excellent ratio between price and quality, you can possess them by competitive price and high quality;
3. The fast and flexible production form aim at the customer require;
4. The deliveries exactly in accordance with customer orders.
5. The fast transportation.
6. Wide in variety, entire in specifications, has high short-circuit breaking capacity, can reach 10KA, it is aesthetic in appearance to design and convenient to install.
7. OB16-63 serial miniature circuit breaker has high breaking capacity, the whole series from 1A to 63A can up to 10KA, and has high breaking potentiality, hold the trend of improve breaking capacity. It is aesthetic in appearance to design and convenient to install.

Overall and Mounting Dimensions

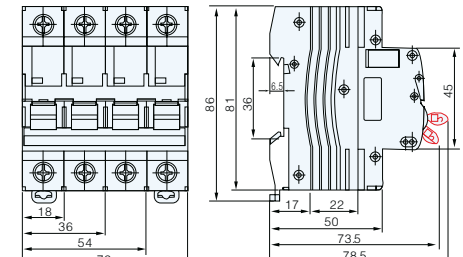

OB8-63 Mini Circuit Breaker



Application

The product is mainly used in AC50/60HZ single-pole 230V or two, three, four-pole 400V circuit for overload and short-circuit protection as well as for unfrequent on-and-off switching electric equipment and lighting circuit under normal condition. The product is suitable for industry, business, building, residence, etc. It is conformity with GB10963,IEC60898 standards.

Main Technical Parameters

Type	OB8-63 MCB
Number of poles	1P、2P、3P、4P
Rated Current(In)	1, 2, 3, 4, 6, 10, 16, 20, 25, 32, 40, 50, 63A
Rated Voltage(Un)	AC 230(240)/400(415)V
Rated frequency	50(60)Hz
Curve	B、C、D
Short-circuit breaking capacity(Icn)	6000A (6kA)
Magnetic releases operate	B curve: between 3 and 5 In C curve: between 5 and 10 In D curve: between 10 and 20 In
Endurance	≥ 4000
Terminal protection	IP20

Product's Advantage

- 1.Our products have the guarantee period of 36 calendar months, that is a high quality and reliability;
- 2.Our products have an excellent ratio between price and quality, you can possess them by competitive price and high quality;
- 3.The fast and flexible production form aim at the customer require;
- 4.The deliveries exactly in accordance with customer orders
- 5.The fast transportation.
- 6.Wide in variety, entire in specifications, has high short-circuit breaking capacity,can reach 10KA , it is aesthetic in appearance to design and convenient to install.
- 7.OB8-63 serial miniature circuit breaker has high breaking capacity, the whole series from 1A to 63A can up to 6KA, and has high breaking potentiality, hold the trend of improve breaking capacity. It is aesthetic in appearance to design and convenient to install.

Overall and Mounting Dimensions

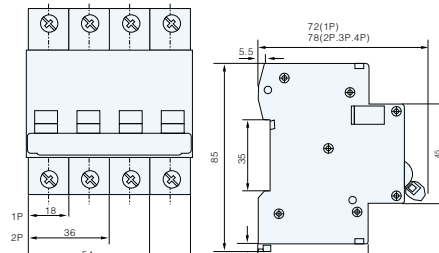

Construction Features

1. Much higher short circuit breaking capacity.
- 2.Dual-connection convenient for both standard busbar and conductor connection.
- 3.Improved safety of operators offered by special design of terminals.
- 4.Much longer service life thanks to energy storage operating mechanism.
- 5.A variety of modular auxiliaries allows for easy and quick installation.
- 6.Enclosure and functional parts made of advanced plastics with flame-retardant,heat-resistant and impulse-proof properties.
- 7.Higher current-limiting capacity ensuring a cost-effective range of products.

OB8-100 Mini Circuit Breaker



Application

The product is used in AC50/60HZ single pole 230V, two, three, four poles 400V, rated current 63 ~ 100A, for protecting the circuit from overload and short circuit. Meanwhile it is applicable to an unfrequent switch over the electric apparatus and lighting circuit under normal condition.

It is conformity with GB14048.2,IEC60947-2s tandards.

Main Technical Parameters

Type	OB-100 MCB
Number of poles	1P、2P、3P、4P
Rated Current(In)	63A,80A,100A
Rated Voltage(Un)	AC 230(240)/400(415)V
Rated frequency	50(60)Hz
Curve	B、C、D
Short-circuit breaking capacity(Icn)	10000A (10kA)
Magnetic releases operate	B curve: between 3 and 5 In C curve: between 5 and 10 In D curve: between 10 and 20 In
Endurance	≥ 4000
Terminal protection	IP20

Product's Advantage

- 1.Our products have the guarantee period of 36 calendar months, that is a high quality and reliability;
- 2.Our products have an excellent ratio between price and quality, you can possess them by competitive price and high quality;
- 3.The fast and flexible production form aim at the customer require;
- 4.The deliveries exactly in accordance with customer orders.
- 5.The fast transportation.
- 6.Wide in variety, entire in specifications, it is aesthetic in appearance to design and convenient to install.

Overall and Mounting Dimensions

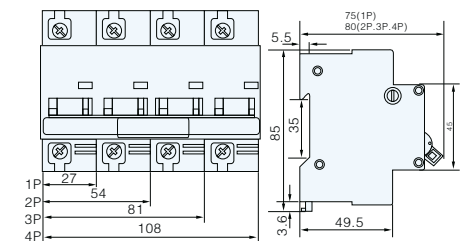

Construction Features

The breaker is characterized by compact design, light weight, elegant appearance, high breaking capacity, swift tripping and long service life.

SL7-DC Mini Circuit Breaker



Detailed Product Description

DC SL7 MCB series mini circuit breaker is used in 50/60HZ, rated voltage 230V 2,3,4 poles 400V, rated current to 63A for overload and short-circuit protection as well as for unrequented switching under normal case. It is used extensively in industry, commercial and household and so on. Overload and short-circuit protection suitable for DC circuit, especially at the fields of communication, electric and electric vehicle and so on.

Main Technical Parameters

- Specialised MCB for DC applications
- Ratings 0.5A, 1A, 2A, 4A, 6A, 10A, 16A, 20A, 25A, 32A, 40A, 50A, 63A
- Type B and C tripping characteristics (details available on request)
- 6kA short circuit capacity (IEC 898)
- 1P (220V DC), 2P (440V DC)
- Current limiting operation under fault conditions
- 18mm modular width per pole
- IP20 finger proof terminals

- Safety terminals ensure that incorrect connection is not possible
- Terminal capacity up to 35mm
- High torque terminals up to 4.5Nm
- Circuit indicator window allowing clear labeling of circuits

- Suitable for DIN rail mounting in OEM / panel builder enclosures
- Suitable for installation in consumer units, design units and MCB distribution boards
- Toggle is padlockable in "ON" or "OFF" position
- Wide range of multi-functional accessories

Product's Advantage

1. 1 pole, 2 pole, 3 pole, 4 pole all possible.
2. the very best quality
3. The best competitive price of you
4. Various specifications
5. caution: power electrodes shall not be improperly connected, lest the current can not be effectively cut off.

Overall and Mounting Dimensions

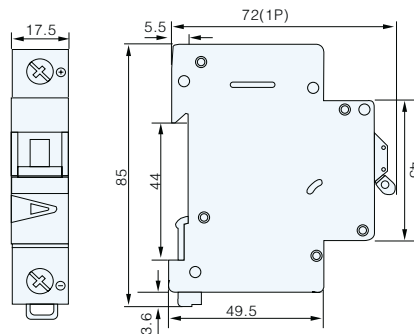

OH1-100 Main Switch



Application

The product is suitable for power distributions and control circuits which are used in AC 50/60HZ, rated current 100A and below, rated voltage is up to 400V. It can mainly used as the chief switch in the terminal combined electrical equipments as well as used for unrequented control all kinds of small power equipments and lightings.

It is suitable for mining industry, building, business, residence, etc. It is conformity with GB14048.3, IEC60947-3 standards.

Main Technical Parameters

Type	OH1-100 MS
Number of poles	1P, 2P, 3P, 4P
Rated Current(I _n)	63A, 80A, 100A
Rated Voltage(U _n)	AC 230(240)/400(415)V
Rated frequency	50(60)Hz
Short-circuit breaking capacity(I _{cn})	3000A
Endurance	≥ 10000
Terminal protection	IP20

Construction Features

The product, used as main switch in terminal electric installations, is applicable to power distribution circuit with rated voltage up to 400V AC and rated frequency 50/60Hz. The product is featured highly stable against abnormal heating and equipped with "on-off" status indicator.

Product's Advantage

1. Our products have the guarantee period of 36 calendar months, that is a high quality and reliability;
2. Our products have an excellent ratio between price and quality, you can possess them by competitive price and high quality;
3. The fast and flexible production form aim at the customer require;
4. The deliveries exactly in accordance with customer orders.
5. The fast transportation.

Overall and mounting dimensions

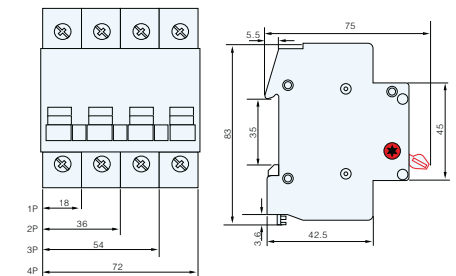

LDG-100 Isolator



Main Technical Parameters

Type	LDG-100 Isolator
Number of poles	1P 18mm 2P 36mm 3P 54mm 4P 72mm
Rated Voltage	230/400V AC
Rated Current	32 40 50 63 80 100A
Rated Breaking Capacity	1.05Un, 3In, cosΦ =0.65
Rated Short-cut Withstanding Current	20In, 1s
Rated Short-cut Connectivity	15In, 0.05s, cosΦ =0.95
Utilization Category	AC-22B
Electrical/Mechanical Endurance	In Un cosΦ =0.8 Unloaded 1700 Loaded 300 Total 2000(no. of operations)
Terminal Capacity(max)	50mm ²
Position(On/Off) Indicating Device	
Safety Lock System	
Standard Conformity	IEC:60947-3:2001
Patented in China	

Overall and Mounting Dimensions

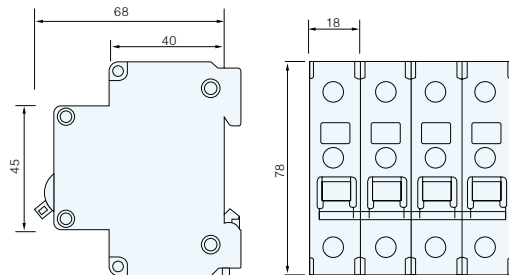

Circuit Breaker Accessories



Application

Applicable to MCB model DZ47-63 & DPN, used for remote control and signaling.

Combination scheme



F2 Auxiliary Contact

■ Contact capacity:

- AC:Un=415V In=3A
Un=240V In=6A
- AC:Un=125V In=1A
Un=48V In=2A
Un=24V In=6A

■ Dielectric strength:KV/1 min

- Electro-mechanical endurance: ≥ 5000
- Mounted on the left side of the MCB DZ47-63 & DPN, indicating "ON", "OFF" status of combined MCB.
- Terminal Connection Height:H1=21mm H2=30mm H3=19mm

S2 Shunt Tripper

- Rated insulating voltage(Ui):500V
- Rated power voltage (Us):AC 400,230,125V
- Operate voltage range:70~100% Us

■ Contact capacity:

- AC:3A/400V
- AC:6A/230V
- AC:9A/125V
- Dielectric strength:2KV/1 min

■ Electro-mechanical endurance: ≥ 4000

- Mounted on the right side of the MCB/RCBO, used to trip the combined MCB/RCBO by remote.
- Terminal Connection Height:H1=21mm

U2+O2 Over-voltage/Under-voltage Tripper

- Rated voltage(Ue):AC 230V
- Rated insulating voltage (Ui):500V
- Over-voltage tripping range:280V ± 5%
- Under-voltage tripping range:170V ± 5%

■ Electro-mechanical endurance: ≥ 4000

- Mounted on the right side of circuit breaker, actuate the combined device to trip in case of under-voltage or over-voltage, effectively prevent the device from closing operation under abnormal power voltage condition.
- Terminal Connection Height:H1=21mm

DZ30 DPN



Application

Protection and control of circuit against overload and short circuits in commercial and household installation.

Main Technical Parameters

Type	DZ30 DPN
Number of poles	1P+N
Rated Current(In)	6、10、16、20、25、32A
Rated Voltage(Un)	AC 230(240)
Rated frequency	50(60)Hz
Short-circuit breaking capacity(Icn)	3000A
Endurance	≥ 40000
Terminal protection	IP20

Construction Features

The pass electric current characteristic of circuit breaker can not be changed with outside mechanical tool ;The accessory which made by ferrous metal should have proper anti-rusting measure; The operating organization must be flexible and reliable, and should have freed function to take off and deduct; the Operate part can not be taken down from the shell outer of products, the shell of product can not influence the operating organization to work.

Overload Trip Characteristic

Testing current(A)	Rated current(A)	Limited time	Appointed result	Start state	Note
1.13 In	all	$t \geq 1h$	non-trip	cold state	
1.45 In	all	$t > 1h$	trip	beat state	The current rise steadily to a fixed value within 5s
2.55 In	all	$1 < t < 60s$	trip	cold state	
5 In	all	$t \geq 0.1s$	non-trip	cold state	Open the supplementary switch,connect the power
10 In	all	$t < 0.1s$	trip	cold state	Open the supplementary switch,connect the power

Product's Advantage

1. Our products have the guarantee period of 36 calendar months,that is a high quality and reliability;
2. Our products have an excellent ratio between price and quality, you can possess them by competitive price and high quality;
3. The fast and flexible production form aim at the customer require;
4. The deliveries exactly in accordance with customer orders
5. The fast transportation.
6. Wide in variety, entire in specifications, has high short-circuit breaking capacity,can reach 4.5KA , it is aesthetic in appearance to design and convenient to install.

Overall and Mounting Dimensions

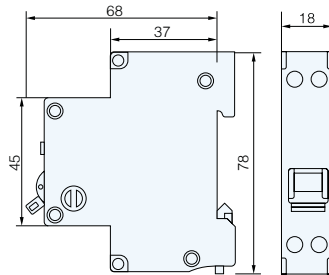

Installation:Suitable for all types of power distribution boxes part match with multi 9.

OL2-63 Series RCCB



Application

The product is used in AC50 / 60HZ two poles 230V, four poles 400V, rated current up to 63A. It can automatically and immediately cut off power supply once someone suffers from electric shock or leakage current above specified & #118alue. It can effectively protect personal security and avoid the damage to equipment. The residual current operated circuit breaker can also function as overload and short-circuit protection and unfrequent changeover of line under normal condition. The product is suitable for industry, business, building, residence ,etc. It is conformity with GB16916.1, IEC61008-1 standards.

Main Technical Parameters

Type	OL2-63 RCCB
Number of poles	2P、4P
Rated Current(In)	25、40、63、80、100A
Rated residual operating current(I Δ n)	10、30、100、300、500mA
Rated residual non-operation Current(I Δ no)	0.5I Δ n
Rated Voltage(Un)	AC 2P:230/240V 4P:400/415V
Residual operating current scope	0.5I Δ n~I Δ n
Residual current off-time	≤ 0.3s
Ultimate short-circuit breaking capacity (Inc)	6000A
Endurance	≥ 4000
Terminal protection	IP20

Product's Advantage

1. Our products have the guarantee period of 36 calendar months, that is a high quality and reliability;
2. Our products have an excellent ratio between price and quality, you can possess them by competitive price and high quality;
3. The fast and flexible production form aim at the customer require;
4. The deliveries exactly in accordance with customer orders.
5. The fast transportation.
6. Adopt electromagnetic style release , can play a leak electricity and electric shock protecting role while breaking in zero Line.

Overall and Mounting Dimensions

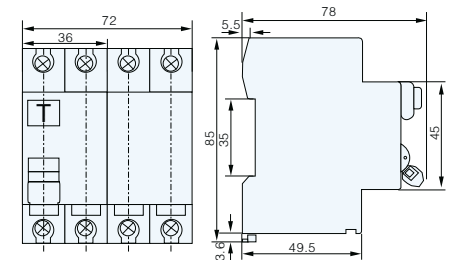

Construction Feature

1. Measuring component and buckling component of products is located between enter line end and entrance line end ;
2. Movement characteristic of products can not be changed with outside mechanical tool ;
3. The operating organization has the free function to take off and buckle;
4. Operate part can not be taken down from the shell outer of products , the shell can not influence the operating organization to work , the accessory group which replace the feelers pressure, should guarantee the feelers pressure does not change while running.

OL7 Series RCCB



Application

The product is used in AC50 / 60HZ two poles 230V, four poles 400V, rated current up to 63A. It can automatically and immediately cut off power supply once someone suffers from electric shock or leakage current above specified & #118alue. It can effectively protect personal security and avoid the damage to equipment. The residual current operated circuit breaker can also function as overload and short-circuit protection and unfrequent changeover of line under normal condition.

The product is suitable for industry, business, building, residence, etc. It is conformity with IEC61008-1 standards.

Main Technical Parameters

Type	OL7 RCCB
Number of poles	2P、4P
Rated Current(In)	25、40、63、80、100A
Rated residual operating current (I Δ n)	10、30、100、300、500mA
Rated residual non-operation Current (I Δ no)	0.5I Δ n
Rated Voltage(Un)	AC 2P:230/240V 4P:400/415V
Residual operating current scope	0.5I Δ n~I Δ n
Residual current off-time	≤ 0.3s
Ultimate short-circuit breaking capacity (Inc)	6000A
Endurance	≥ 4000
Terminal protection	IP20

Construction Feature

- 1.Measuring component and buckling component of products is located between enter line end and entrance line end ;
- 2.Movement characteristic of products can not be changed with outside mechanical tool ;
- 3.The operating organization has the free function to take off and buckle;
- 4.Operate part can not be taken down from the shell outer of products , the shell can not influence the operating organization to work , the accessory group which replace the feelers pressure, should guarantee the feelers pressure does not change while running.

Product's Advantage

- 1.Our products have the guarantee period of 36 calendar months,that is a high quality and reliability;
- 2.Our products have an excellent ratio between price and quality, you can possess them by competitive price and high quality;
- 3.The fast and flexible production form aim at the customer require;
- 4.The deliveries exactly in accordance with customer orders.
- 5.The fast transportation.
- 6.Adopt electromagnetic style release , can play a leak electric-ity and electric shock protecting role while breaking in zero Line.

Overall and Mounting Dimensions

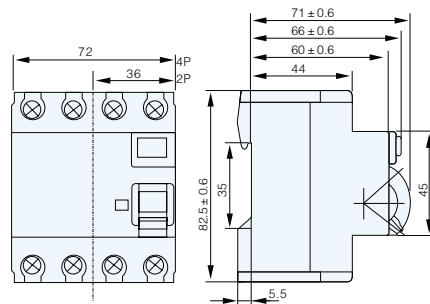

OL8-63 RCCB



Main technical parameters

Type	OL8-63
Standrd	IEC1008, GB 16916, BS EN61008
Rated Voltage(Un)	2pole:230V AC 4pole: 400V AC
Rated Current(In)	25,40,63A
Rated residual operating current(I Δ n)	30,100,300,500mA
Rated residual non-operation current(I Δ no)	0.5I Δ n
Residual current off-time	≤ 0.1S
Minimum & #118alue of rated making and breaking capacity(I _m)	500A
Rated conditional short-circuit current(Inc)	3KA
Installation	On symmetrical DIN rail

Overall and mounting dimensions

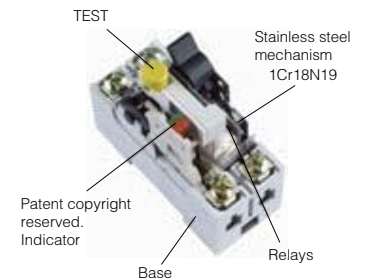
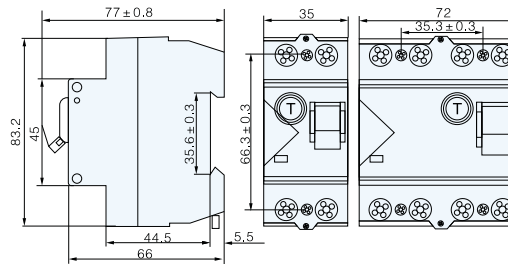

Operation Principle Fie

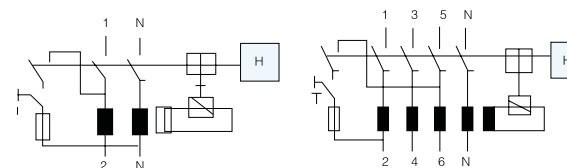

OB7L-32 series RCBO



Main Technical Parameters

Type	OB7L-32 series RCBO
N+L 18mm dual arc-extinction system	
Rated Voltage	220-240V AC
Rated Current	10 16 20 32A
Breaking Capacity	4.5kA
Standard Conformity	IEC:60898:1995
Electrical/Mechanical Endurance	4000(no. of operations)
Type/Series	C (5-10In) D (10-14In)
Ambient Temperature	30 ^{±5}
Tropical Test	Class 2 (relative humidity 95% at 55)
Terminal Capacity(max)	10mm ²
Mounting	Clip on DIN Rail
Patented in China	

Overall and Mounting Dimensions

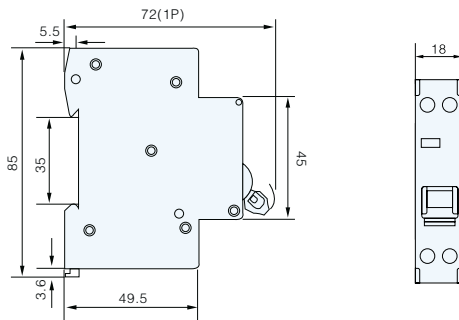

OBL16-63 RCCB



Application

OBL16-100 Residual Current Circuit Breaker provide the function of isolation switching and earth leakage protection of electrical circuits. And also provide the indirect protection of the operator's body against the dangerous effects of electric current and provide the protection of the fire caused by the electrical circuit fault.

Main Technical Parameters

Type	OBL16-63
Number of poles	2P、4P
Rated Current(In)	25、40、63A
Rated residual operating current(I Δ n)	30、100、300、500mA
Rated residual non-operation Current(I Δ no)	0.5I Δ n
Rated Voltage(Un)	AC 230(240)/400(415)V
Residual operating current scope	0.5I Δ n~I Δ n
Residual current off-time	≤ 0.3s
Type	A、AC
Rated conditional short-circuit current Inc	6000A
Endurance	≥ 4000
Terminal protection	IP20

Construction Feature

1. Provides protection against earth fault/leakage current and function of isolation.
2. High short-circuit current withstand capacity
3. Applicable to terminal and pin/fork type busbar connection
4. Equipped with finger protected connection terminals
5. Fire resistant plastic parts endures abnormal heating and strong impact
6. Automatically disconnect the circuit when earth fault/leakage current occurs and exceeds the rated sensitivity.
7. Independent of power supply and line voltage, and free from external interference, voltage fluctuation.
8. High current rating up to 100A.

Product's Advantage

1. Our products have the guarantee period of 36 calendar months, that is a high quality and reliability;
2. Our products have an excellent ratio between price and quality, you can possess them by competitive price and high quality;
3. The fast and flexible production form aim at the customer require;
4. The deliveries exactly in accordance with customer orders.
5. The fast transportation.
6. Adopt electromagnetic style release, can play a leak electricity and electric shock protecting role while breaking in zero Line.

Overall and Mounting Dimensions

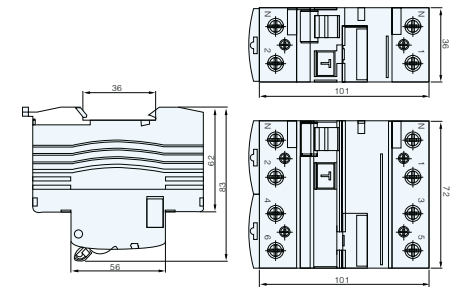

OBL16-100 RCCB



Application

OBL16-100 Residual Current Circuit Breaker provide the function of isolation switching and earth leakage protection of electrical circuits. And also provide the indirect protection of the operator's body against the dangerous effects of electric current and provide the protection of the fire caused by the electrical circuit fault.

Main technical parameters

Type	OBL16-100
Number of poles	2P、4P
Rated Current(In)	63、80、100A
Rated residual operating current(I Δ n)	10、30、100、300、500mA
Rated residual non-operation Current(I Δ no)	0.5I Δ n
Rated Voltage(Un)	AC 230(240)/400(415)V
Residual operating current scope	0.5I Δ n-I Δ n
Residual current off-time	≤ 0.3s
Type	A、AC
Ultimate short-circuit breaking capacity (Inc)	10000A
Endurance	≥ 4000
Terminal protection	IP20

Product's advantage

- 1.Our products have the guarantee period of 36 calendar months,that is a high quality and reliability;
- 2.Our products have an excellent ratio between price and quality, you can possess them by competitive price and high quality;
- 3.The fast and flexible production form aim at the customer require;
- 4.The deliveries exactly in accordance with customer orders.
- 5.The fast transportation.
- 6.Adopt electromagnetic style release , can play a leak electricity and electric shock protecting role while breaking in zero Line.

Overall and Mounting Dimensions

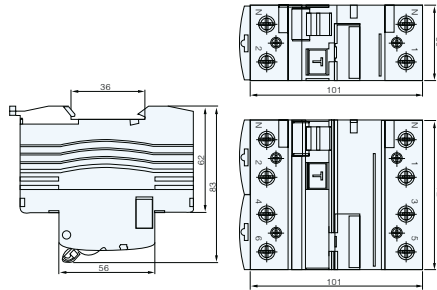

Construction Features

1. Provides protection against earth fault/leakage current and function of isolation.
2. High short-circuit current withstand capacity
3. Applicable to terminal and pin/fork type busbar connection
4. Equipped with finger protected connection terminals
5. Fire resistant plastic parts endures abnormal heating and strong impact
6. Automatically disconnect the circuit when earth fault/leakage current occurs and exceeds the rated sensitivity.
7. Independent of power supply and line voltage, and free from external interference, voltage fluctuation.
8. High current rating up to 100A.

OBL1-63 I RCCB



Application

OBL1-63 I Residual Current Circuit Breaker provide the function of isolation switching and earth leakage protection of electrical circuits. And also provide the indirect protection of the operator's body against the dangerous effects of electric current and provide the protection of the fire caused by the electrical circuit fault.

Main Technical Parameters

Type	OBL1-63 I
Number of poles	2P、4P
Rated Current(In)	25、40、63、80、100A
Rated residual operating current(I Δ n)	10、30、100、300、500mA
Rated residual non-operation Current(I Δ no)	0.5I Δ n
Rated Voltage(Un)	AC 2P: 230/240V 4P: 400/415V
Residual operating current scope	0.5I Δ n-I Δ n
Residual current off-time	≤ 0.3s
Type	A、AC
Ultimate short-circuit breaking capacity (Inc)	6000A
Endurance	≥ 4000
Terminal protection	IP20

Product's Advantage

- 1.Our products have the guarantee period of 36 calendar months,that is a high quality and reliability;
- 2.Our products have an excellent ratio between price and quality, you can possess them by competitive price and high quality;
- 3.The fast and flexible production form aim at the customer require;
- 4.The deliveries exactly in accordance with customer orders
- 5.The fast transportation.
- 6.Adopt electromagnetic style release , can play a leak electricity and electric shock protecting role while breaking in zero Line.

Overall and Mounting Dimensions

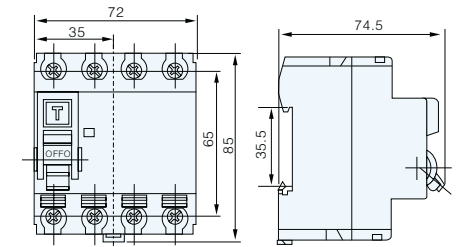

Construction Feature

- 1.Measuring component and buckling component of products is located between enter line end and entrance line end ;
- 2.Movement characteristic of products can not be changed with outside mechanical tool ;
- 3.The operating organization has the free function to take off and buckle;
- 4.Operate part can not be taken down from the shell outer of products , the shell can not influence the operating organization to work , the accessory group which replace the feelers pressure, should guarantee the feelers pressure does not change while running.

OBL1-63 II RCCB



Application

OBL1-63 II Residual Current Circuit Breaker provide the function of isolation switching and earth leakage protection of electrical circuits. And also provide the indirect protection of the operator's body against the dangerous effects of electric current and provide the protection of the fire caused by the electrical circuit fault.

Main Technical Parameters

Type	OBL1-63 II
Number of poles	2P、4P
Rated Current(In)	25、40、63、80、100A
Rated residual operating current(I Δ n)	10、30、100、300、500mA
Rated residual non-operation Current(I Δ no)	0.5I Δ n
Rated Voltage(Un)	AC 2P: 230/240V 4P: 400/415V
Residual operating current scope	0.5I Δ n-I Δ n
Residual current off-time	≤ 0.3s
Type	A、AC
Ultimate short-circuit breaking capacity (Inc)	6000A
Endurance	≥ 4000
Terminal protection	IP20

Construction Feature

- 1.Measuring component and buckling component of products is located between enter line end and entrance line end ;
- 2.Movement characteristic of products can not be changed with outside mechanical tool ;
- 3.The operating organization has the free function to take off and buckle;
- 4.Operate part can not be taken down from the shell outer of products , the shell can not influence the operating organization to work , the accessory group which replace the feelers pressure, should guarantee the feelers pressure does not change while running.

Product's Advantage

- 1.Our products have the guarantee period of 36 calendar months,that is a high quality and reliability;
- 2.Our products have an excellent ratio between price and quality, you can possess them by competitive price and high quality;
- 3.The fast and flexible production form aim at the customer require;
- 4.The deliveries exactly in accordance with customer orders
- 5.The fast transportation.
- 6.Adopt electromagnetic style release , can play a leak electricity and electric shock protecting role while breaking in zero Line.

Overall and Mounting Dimensions

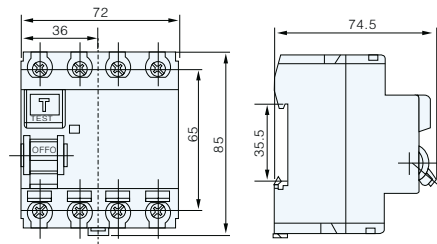

OBL1-63 III RCCB



Application

OBL1-63 III Residual Current Circuit Breaker provide the function of isolation switching and earth leakage protection of electrical circuits. And also provide the indirect protection of the operator's body against the dangerous effects of electric current and provide the protection of the fire caused by the electrical circuit fault.

Main Technical Parameters

Type	OBL1-63 I
Number of poles	2P、4P
Rated Current(In)	25、40、63、80、100A
Rated residual operating current(I Δ n)	10、30、100、300、500mA
Rated residual non-operation Current(I Δ no)	0.5I Δ n
Rated Voltage(Un)	AC 2P: 230/240V 4P: 400/415V
Residual operating current scope	0.5I Δ n-I Δ n
Residual current off-time	≤ 0.3s
Type	A、AC
Ultimate short-circuit breaking capacity (Inc)	6000A
Endurance	≥ 4000
Terminal protection	IP20

Construction Feature

- 1.Measuring component and buckling component of products is located between enter line end and entrance line end ;
- 2.Movement characteristic of products can not be changed with outside mechanical tool ;
- 3.The operating organization has the free function to take off and buckle;
- 4.Operate part can not be taken down from the shell outer of products , the shell can not influence the operating organization to work , the accessory group which replace the feelers pressure, should guarantee the feelers pressure does not change while running.

Product's Advantage

- 1.Our products have the guarantee period of 36 calendar months,that is a high quality and reliability;
- 2.Our products have an excellent ratio between price and quality, you can possess them by competitive price and high quality;
- 3.The fast and flexible production form aim at the customer require;
- 4.The deliveries exactly in accordance with customer orders
- 5.The fast transportation.
- 6.Adopt electromagnetic style release , can play a leak electricity and electric shock protecting role while breaking in zero Line.

Overall and Mounting Dimensions

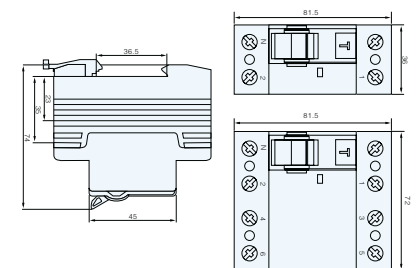

DZ30F1-32L RCBO



Application

The products provide protection against earth leakage faults, overloads, short circuits and overvoltage in commercial and domestic installation.

The RCBO with both disconnected neutral and phase guarantees its proper actuation against earth leakage faults even when the neutral and phase are wrongly connected.

The electronic RCBO incorporate a filtering device preventing the risks of unwanted due to transient voltages and transient currents. Positive contact indication in accordance with 16th edition of the IEE wiring regulations

Main Technical Paramete

Type	DZ30F1-32L
Number of poles	1P+N
Rated Current(In)	6, 10, 16, 20, 25, 32A
Rated residual operating current(I Δ n)	30, 100, 300mA
Rated residual non-operation Current(I Δ no)	AC 230(240)V
Residual operating current scope	0.5I Δ n~I Δ n
Residual current off-time	≤ 0.3s
Ultimate short-circuit breaking capacity (Inc)	6000A
Endurance	≥ 4000
Terminal protection	IP20

Product's Advantage

1. Our products have the guarantee period of 36 calendar months, that is a high quality and reliability;
2. Our products have an excellent ratio between price and quality, you can possess them by competitive price and high quality;
3. The fast and flexible production form aim at the customer require;
4. The deliveries exactly in accordance with customer orders.
5. The fast transportation.
6. Adopt electromagnetic style release, can play a leak electricity and electric shock protecting role while breaking in zero Line.

Overall and Mounting Dimensions

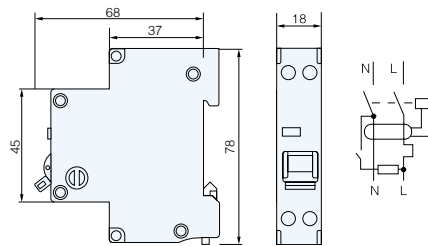

Construction Feature

1. Measuring component and buckling component of products is located between enter line end and entrance line end;
2. Movement characteristic of products can not be changed with outside mechanical tool;
3. The operating organization has the free function to take off and buckle;
4. Operate part can not be taken down from the shell outer of products, the shell can not influence the operating organization to work, the accessory group which replace the feelers pressure, should guarantee the feelers pressure does not change while running.

DZ30LE Series RCBO



Application

The products provide protection against earth leakage faults, overloads, short circuits and overvoltage in commercial and domestic installation.

The RCBO with both disconnected neutral and phase guarantees its proper actuation against earth leakage faults even when the neutral and phase are wrongly connected.

The electronic RCBO incorporate a filtering device preventing the risks of unwanted due to transient voltages and transient currents. Positive contact indication in accordance with 16th edition of the IEE wiring regulations

Main Technical Paramete

Type	DZ30LE RCBO
Number of poles	1P+N
Rated Current(In)	6, 10, 16, 20, 25, 32A
Rated residual operating current(I Δ n)	30, 100, 300mA
Rated residual non-operation Current(I Δ no)	AC 230(240)V
Residual operating current scope	0.5I Δ n~I Δ n
Residual current off-time	≤ 0.3s
Ultimate short-circuit breaking capacity (Inc)	6000A
Endurance	≥ 4000
Terminal protection	IP20

Product's Advantage

1. Our products have the guarantee period of 36 calendar months, that is a high quality and reliability;
2. Our products have an excellent ratio between price and quality, you can possess them by competitive price and high quality;
3. The fast and flexible production form aim at the customer require;
4. The deliveries exactly in accordance with customer orders.
5. The fast transportation.
6. Adopt electromagnetic style release, can play a leak electricity and electric shock protecting role while breaking in zero Line.

Overall and Mounting Dimensions

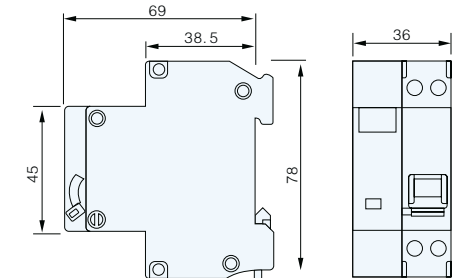

Construction Feature

1. Measuring component and buckling component of products is located between enter line end and entrance line end;
2. Movement characteristic of products can not be changed with outside mechanical tool;
3. The operating organization has the free function to take off and buckle;
4. Operate part can not be taken down from the shell outer of products, the shell can not influence the operating organization to work, the accessory group which replace the feelers pressure, should guarantee the feelers pressure does not change while running.

DZ47LE Series RCBO



Application

DZ47L-63E residual current circuit breaker simply fits onto the right hand side of any DZ47 miniature circuit breaker which forms DZ47LE to provide a high level of protection against earth leakage faults in addition to the overload and over current protection by the MCB alone.

Specification

Type	DZ40L-63E RCBO
Number of poles	2P、4P
Rated Current(In)	25, 32, 40, 63A
Rated residual operating current(I Δ n)	AC 230(240)/400(415)V
Rated residual non-operation Current(I Δ no)	10、30、100、300、500mA
Residual operating current scope	0.5I Δ n~I Δ n
Residual current off-time	≤ 0.3s
Ultimate short-circuit breaking capacity (Inc)	3000A
Endurance	≥ 4000
Terminal protection	IP20

Product's Advantage

- 1.Our products have the guarantee period of 36 calendar months,that is a high quality and reliability;
- 2.Our products have an excellent ratio between price and quality, you can possess them by competitive price and high quality;
- 3.The fast and flexible production form aim at the customer require;
- 4.The deliveries exactly in accordance with customer orders
- 5.The fast transportation.
- 6.Adopt electromagnetic style release , can play a leak electricity and electric shock protecting role while breaking in zero Line.

Overall and Mounting Dimensions

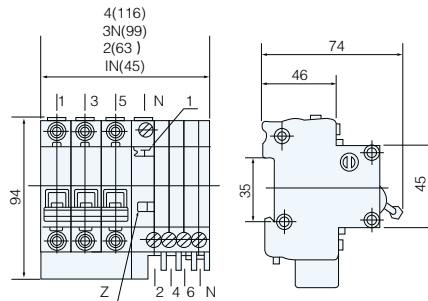

Construction Feature

- 1.Measuring component and buckling component of products is located between enter line end and entrance line end ;
- 2.Movement characteristic of products can not be changed with outside mechanical tool ;
- 3.The operating organization has the free function to take off and buckle;
- 4.Operate part can not be taken down from the shell outer of products , the shell can not influence the operating organization to work , the accessory group which replace the feelers pressure, should guarantee the feelers pressure does not change while running.

OB8L-40 Series RCBO



Application

The product serves in the line of AC 50HZ, rated voltage 230V and rated current up to 40A to automatically and immediately cut off power supply once someone suffers from electric shock or leakage current above specified & #118alue. It can effectively protect personal security and avoid the damage to equipments. The circuit-breaker can also function as overload and shortcircuit protection and unfrequent changeover of line under normal condition.

Main Technical Paramete

Type	OB8L-40 RCBO
Number of poles	2P、4P
Rated Current(In)	6A,10A,16A,20A,25A,32A,40A
Rated residual operating current(I Δ n)	0.01A, 0.03A, 0.1A, 0.3A
Rated residual non-operation Current(I Δ no)	0.5I Δ n
Rated Voltage(Un)	AC 2P:230/240V 4P:400/415V
Residual operating current scope	0.5I Δ n~I Δ n
Residual current off-time	≤ 0.3s
Ultimate short-circuit breaking capacity (Inc)	6000A
Endurance	≥ 4000
Terminal protection	IP20

Product's Advantage

- 1.Our products have the guarantee period of 36 calendar months,that is a high quality and reliability;
- 2.Our products have an excellent ratio between price and quality, you can possess them by competitive price and high quality;
- 3.The fast and flexible production form aim at the customer require;
- 4.The deliveries exactly in accordance with customer orders
- 5.The fast transportation.
- 6.Adopt electromagnetic style release , can play a leak electricity and electric shock protecting role while breaking in zero Line.

Overall and Mounting Dimensions

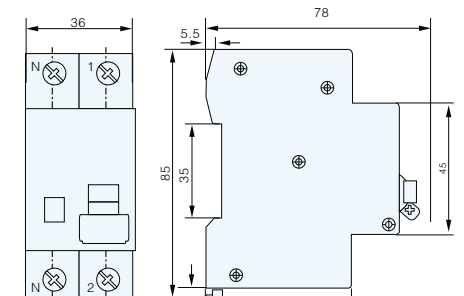

Construction Feature

- 1.Without auxiliary power supply, the product is designed with strong immunity and extending protection range against residual current.
2. With higher rated ultimate short circuit, up to 6KA.
3. Reliable, accurate and convenient adjustment of product instantaneous action is ensured.
4. Service life of product has been greatly enhanced through specially designed trippingmechanism.

OB8LE-40 Series RCBO



Application

The product serves in the line of AC 50HZ, rated voltage 230V and rated current up to 40A to automatically and immediately cut off power supply once someone suffers from electric shock or leakage current above specified & #118alue. It can effectively protect personal security and avoid the damage to equipments. The circuit-breaker can also function as overload and shortcircuit protection and unfrequent changeover of line under normal condition.

Main Technical Paramete

Type	OB8LE-40 RCBO
Number of poles	2P、4P
Rated Current(In)	6A, 10A, 16A, 20A, 25A, 32A, 40A.
Rated residual operating current(I Δ n)	0.03A, 0.1A
Rated residual non-operation Current(I Δ no)	0.5I Δ n
Rated Voltage(Un)	AC 2P:230/240V 4P:400/415V
Residual operating current scope	0.5I Δ n~I Δ n
Residual current off-time	≤ 0.3s
Ultimate short-circuit breaking capacity (Inc)	6000A
Endurance	≥ 4000
Terminal protection	IP20

Construction Feature

1. With higher rated ultimate short circuit, up to 6KA.
2. Reliable, accurate and convenient adjustment of product instantaneous action ensured.
3. Service life of product has been greatly enhanced through specially designed tripping mechanism.

Product's Advantage

1. Our products have the guarantee period of 36 calendar months, that is a high quality and reliability;
2. Our products have an excellent ratio between price and quality, you can possess them by competitive price and high quality;
3. The fast and flexible production form aim at the customer require;
4. The deliveries exactly in accordance with customer orders
5. The fast transportation.
6. Adopt electromagnetic style release, can play a leak electricity and electric shock protecting role while breaking in zero Line.

Overall and Mounting Dimensions

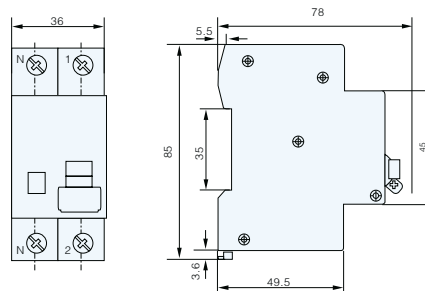

OL11-32 Series RCBO



Application

- Protection against the effects of earth leakage overload and short circuit currents.
- 2P switching of ph&N, Phase only protected against overloads and short circuits.
- In commercial, industrial and domestic electrical distribution systems.
- Note: must not be used as the sole means of providing protection against direct contact.
- The RCBO incorporates a residual current operated electromagnetic release which operates without any auxiliary source of supply to open a circuit automatically in the case of an earth leakage fault between phase and earth greater than or equal to In. The RCBO combined MCB&RCCB provides: Protection against indirect contact; Complementary protection against direct contact; Protection for the installation against insulation faults.

Main Technical Paramete

Type	OL11-32
Number of poles	1P+N
Rated Current(In)	1, 2, 3, 4, 6, 10, 16, 20, 25, 32A
Rated operating current(I Δ n)	30, 100mA
Rated Voltage(Un)	AC 230(240) V
Residual operating current scope	0.5I Δ n~I Δ n
Residual current off-time	≤ 0.3s
Ultimate short-circuit breaking capacity(Icn)	10000A(10KA)
Endurance	≥ 4000
Terminal protection	IP20

Construction Feature

Small size, high breaking capacity.

Overall and Mounting Dimensions

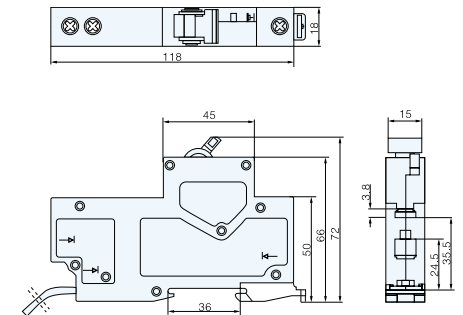

Product's Advantage

1. Our products have the guarantee period of 36 calendar months, that is a high quality and reliability;
2. Our products have an excellent ratio between price and quality, you can possess them by competitive price and high quality;
3. The fast and flexible production form aim at the customer require;
4. The deliveries exactly in accordance with customer orders
5. he fast transportation.
6. Adopt electromagnetic style release, can play a leak electricity and electric shock protecting role while breaking in zero Line.

OL16-32 Series RCBO



Application

- Elegant appearance; cover and handle in arc shape make comfortable operation.
- Contact position indicating window
- Transparent cover designed to carry label.
- In case of overload to protected circuit, RCBO handle trips and stays at central position, which enables a quick solution to the faulty line. The handle cannot stay in such position when operated manually.
- MCB handle can be locked either at "ON" position or at "OFF" position to prevent unwanted operation of the product.
- Provides protection against earth fault/leakage current, short-circuit and overload
- High short-circuit capacity
- Provides complementary protection against direct contact by human body.
- Effectively protects electric equipment against insulating failure
- Contact position indication
- Provides protection against over-voltage

Main Technical Paramete

Type	electronic type
Residual current characteristics	AC
Pole No.	1P+N
Tripping curve	B, C
Rated short-circuit capacity	10000A
Rated current (A)	6, 10, 16, 20, 25, 32
Rated voltage	230V AC
Rated frequency	50/60Hz
Rated residual operating current(A)	0.03, 0.1
Tripping duration	instantaneous $\leq 0.1s$
Electro-mechanical endurance	4000 cycles
Connection terminal	pillar terminal with clamp
Connection capacity	Flexible conductor 10mm ² Rigid conductor 16mm ²
Installation	On symmetrical DIN rail 35mm Panel mounting

Construction Feature

Small size, high breaking capacity.

Product's Advantage

1. Our products have the guarantee period of 36 calendar months, that is a high quality and reliability;
2. Our products have an excellent ratio between price and quality, you can possess them by competitive price and high quality;
3. The fast and flexible production form aim at the customer require;
4. The deliveries exactly in accordance with customer orders.
5. The fast transportation.
6. Adopt electromagnetic style release, can play a leak electricity and electric shock protecting role while breaking in zero Line.

Overall and Mounting Dimensions

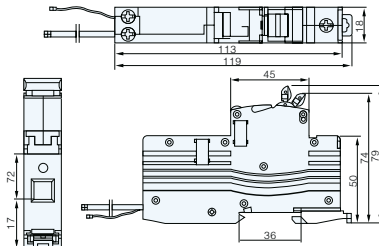

JVB16 Bell



Application

Be applicable to circuit with rated voltage 230V, rated frequency 50Hz/60Hz and rated current not exceeding 63A, providing the function of sound warning and prompting.

Main Technical Paramete

Type	JVB16
Rated Voltage	AC 230(240) V, 24V, 12V, 8V
Rated frequency	50(60)Hz

Overall and Mounting Dimensions

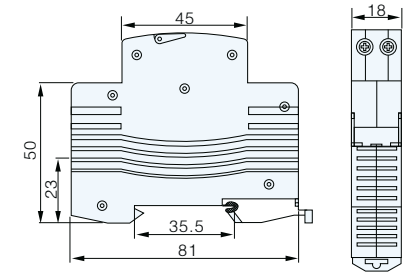

Construction Feature

The product is of safety insulating type. Preferable components are used and secure high performances to the product: 0.5 quality silicon steel is adopted for less non-load consumption and less noise; Special framework of the coil bobbin has high insulation level; well-designed terminal case ensures easy and firm terminal connection. The functioning part is installed in the moulded case after being insulated.

1. Temperature rising is less than -30°C with load less than 8VA.
2. Output voltage has high accuracy with tolerance within 3% of rated output voltage.
3. The product can withstand over-load up to 25% within 24 hours.

Product's Advantage

1. Our products have the guarantee period of 36 calendar months, that is a high quality and reliability;
2. Our products have an excellent ratio between price and quality, you can possess them by competitive price and high quality;
3. The fast and flexible production form aim at the customer require;
4. The deliveries exactly in accordance with customer orders.
5. The fast transportation.

BT8-8 Bell Transformer



Application

Bell transformer is applicable to circuit of AC 50Hz, operating voltage up to 250V. With output power capacity 3.8VA and 8VA, the product functions as ideal and safe power supply for household door bell. Standard EN61558-1 EN61558-2-8

Main Technical Paramete

Type	Rated Output Power P2(VA)	Rated Voltage		Current w/o Load I0(A)	Power consumption w/o load P0(W)	Coil Temperature Rising Δt m(°C)
		Primary U1(V)	Secondary U2(V)			
BT - 3.8	3.8	230(240)	12 16 24	0.011	0.5	30
BT - 8	8	230 (240)	4 6 8 10 12 16 24	0.032	0.9	45

Construction Feature

The product is of safety insulating type. Preferable components are used and secure high performances to the product: 0.5 quality silicon steel is adopted for less non-load consumption and less noise; Special framework of the coil bobbin has high insulation level; well-designed terminal case ensures easy and firm terminal connection. The functioning part is installed in the moulded case after being insulated.

1. Temperature rising is less than -30°C with load less than 8VA.
2. Output voltage has high accuracy with tolerance within 3% of rated output voltage.
3. The product can withstand over-load up to 25% within 24 hours.

Product's Advantage

1. Our products have the guarantee period of 36 calendar months, that is a high quality and reliability;
2. Our products have an excellent ratio between price and quality, you can possess them by competitive price and high quality;

3. The fast and flexible production form aim at the customer require;
4. The deliveries exactly in accordance with customer orders
5. The fast transportation

Overall and Mounting Dimensions

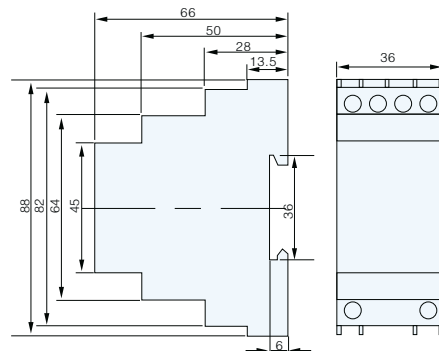

BT16-8 Bell Transformer



Application

Bell transformer is applicable to circuit of AC 50Hz, operating voltage up to 250V. With output power capacity 3.8VA and 8VA, the product functions as ideal and safe power supply for household door bell. Standard EN61558-1 EN61558-2-8

Main Technical Paramete

Type	Rated Output Power P2(VA)	Rated Voltage		Current w/o Load I0(A)	Power consumption w/o load P0(W)	Coil Temperature Rising Δt m(°C)
		Primary U1(V)	Secondary U2(V)			
BT16 - 8	8	230 (240)	8 12 16 24	37 ± 8	0.9	50

1. Product type & designation, rated power, input voltage and output voltage and quantity are required to be specified.
2. Special requirements are subject to further discussion.

Construction Feature

The product is of safety insulating type. Preferable components are used and secure high performances to the product: 0.5 quality silicon steel is adopted for less non-load consumption and less noise; Special framework of the coil bobbin has high insulation level; well-designed terminal case ensures easy and firm terminal connection. The functioning part is installed in the moulded case after being insulated.

1. Temperature rising is less than 30°C with load less than 8VA.
2. Output voltage has high accuracy with tolerance within 3% of rated output voltage.
3. The product can withstand over-load up to 25% within 24 hours.

Product's Advantage

1. Our products have the guarantee period of 36 calendar months, that is a high quality and reliability;
2. Our products have an excellent ratio between price and quality, you can possess them by competitive price and high quality;

3. The fast and flexible production form aim at the customer require;
4. The deliveries exactly in accordance with customer orders
5. The fast transportation.

Overall and Mounting Dimensions

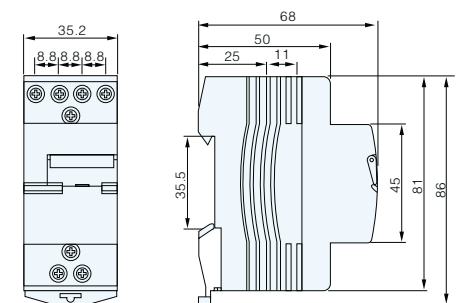

OL9-125

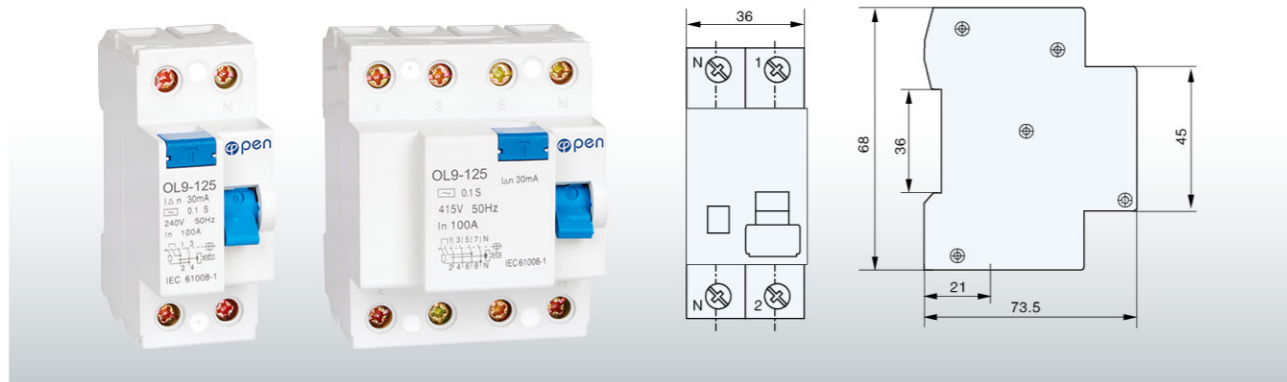

Construction and Feature

- Provides protection against earth fault/leakage current and function of isolation.
- High current rating up to 125A.
- Applicable to terminal and pin/fork type busbar connection.
- Fire resistant plastic parts endures abnormal beating and strong impact.
- Automatically disconnect the circuit when earth fault/leakage current Occurs and exceeds therated sensitivity.
- Independent of power supply and line voltage and free frOm external interference voltage fluctuation.

Technical Data

- Mode: electro-magnetic type electronic type
- Residual current characteristics: A, AC
- Pole No.: 2, 4
- Rated making and breaking capacity: 630A
- Rated current(A): 25, 40, 63, 80, 100, 125
- Rated voltage: AC 230(240)/400(415)
- Rated frequency: 50/60Hz
- Rated residual operating current I_{Δn}(A): 0.03, 0.1, 0.3, 0.5
- Rated residual non operating current I_{Δno}: 0.5I_{Δn}
- Rated conditional short-circuit current I_{nc}: 6kA
- Rated conditional residual shod-circuit current I_{Δc}: 6kA
- Tripping duration: instantaneous tripping ≤ 0.1s
- Residual tripping current range: 0.5I_{Δn} ~ I_{Δn}
- Electro-mechanical endurance: Not less than 4000
- Connection capacity: Rigid conductor 35mm²
- Terminal Connection Height: 21mm
- Connection terminal:
 - Pillar terminal with clamp
 - Fastening torque: 2.5Nm
- Installation:
 - On symmetrical DIN rail 35mm
 - Panel mounting
- Protection class: IP20

Overall & Installation Dimensions

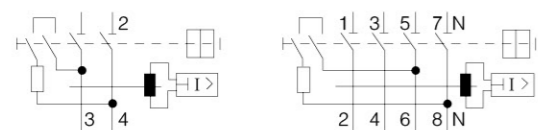

Residual Current Action Breaking Time

type	I _n /A	I _{Δn} /A	Residual Current(I _Δ)Is Corresponding To The Following Breaking Time(S)				
			I _{Δn}	2I _{Δn}	5I _{Δn}	5A,10A,20A,50A,100A,200A,500A	
general type	any value	any value	6.3	0.15	0.04	0.04	Max Break-time
S type	≥ 25	> 0.03	0.5	0.2	0.15	0.15	Max Break-time
			0.13	0.06	0.05	0.04	Min non-driving time

OL15-63



Construction and Feature

- Provides protection against earth fault/leakage current and function of isolation.
- High short-circuit current withstand capacity.
- Applicable to terminal and pin/fork type busbar connection.
- Equipped with finger protented connection terminals.
- Fire resistant plastic parts endures abnormal heating and strong impact.
- Automatically disconnect the circuit when earth fault/leakage current occurs and exceeds the rated sensitivity.
- Independent of power supply and line voltage, and free from external interference,voltage fluctuation.

Technical Data

- Mode: electro-magnetic type, electronic type
- Residual current characteristics: A, AC
- Pole No.: 2,4
- Rated making and breaking capacity: 500A(I_n=25A,32A,40A) or 630A(I_n=63A)
- Rated current(A): 16,25,40,63
- Rated voltage: AC 230/400V
- Rated frequency: 50/60Hz
- Rated residual operating current I_{Δn}(A): 0.03,0.1,0.3,0.5
- Rated residual non operating current I_{Δno}: 0.5I_{Δn}
- Rated conditional short-circuit current I_{nc}: 10kA
- Rated conditional residual short-circuit current I_{Δc}: 10kA
- Residual tripping current range: 0.5I_{Δn} ~ I_{Δn}
- Residual current characteristics: A, AC
- Terminal Connection Height: 21mm
- Electro-mechanical endurance: 4000 cycles
- Connection capacity: Rigid conductor 25mm²
- Connection terminal: Screw terminal
- Pillar terminal with clamp Fastening torque: 2.0N.m
- Installation:
 - On symmetrical DIN rail 35.5mm
 - Panel mounting
- Protection class:IP20

Residual Current Circuit Breaker Tripping Current Range

type	Tripping current I _Δ /A	
	I _{Δn} > 0.01A	I _{Δn} ≤ 0.1A
AC	0.5I _{Δn} < I _Δ < I _{Δn}	
A	0.5I _{Δn} ≤ I _Δ < 1.4I _{Δn}	0.35I _{Δn} ≤ I _Δ ≤ 2I _{Δn}
	0.25I _{Δn} ≤ I _Δ < 1.4I _{Δn}	0.25I _{Δn} ≤ I _Δ ≤ 2I _{Δn}
	0.11I _{Δn} ≤ I _Δ < 1.4I _{Δn}	0.11I _{Δn} ≤ I _Δ ≤ 2I _{Δn}

Overall & Installation Dimensions

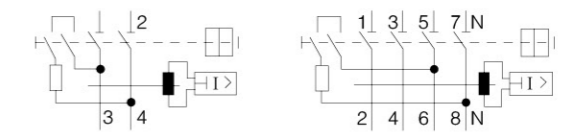

Residual Current Action Breaking Time

type	I _n /A	I _{Δn} /A	Residual Current(I _Δ)Is Corresponding To The Following Breaking Time(S)				
			I _{Δn}	2I _{Δn}	5I _{Δn}	5A,10A,20A,50A,100A,200A,500A	
general type	any value	any value	0.3	0.15	0.04	0.04	Max Break-time
S type	≥ 25	> 0.03	0.5	0.2	0.15	0.15	Max Break-time
			0.13	0.06	0.05	0.04	Min non-driving time

DZ108(3VE) Moulded Case Circuit Breaker



Application

DZ108(3VE) series circuit breaker is suitable for the circuit with voltage up to 660V, current 0.1~ 63A, frequency 50/60Hz. It can infrequently break and connect the motor with AC3 load, distribution line or other electrical equipment, can protect overload or short-circuit as well.

Main Technical Parameters

Table 1

Type	Rated current (A)	Release Current Setting range(A)	Choices of auxiliary contacts (A)	Order No. Article No.	Choices of auxiliary contacts
DZ108-20(3VE1)	0.16	0.1-0.16	1.9	-2BU00	1005 without auxiliary contacts
	0.25	0.16-0.25	3	-2CU00	
	0.4	0.25-0.4	4.8	-2DU00	
	0.63	0.4-0.63	7.5	-2EU00	1015 1NO+1NC
	1	0.63-1	12	-2FU00	
	1.6	1-1.6	19.2	-2GU00	
	2.5	1.6-2.5	30	-2HU00	
	3.2	2-3.2	38	-8HU00	1025 2NO
	4	2.5-4	48	-2JU00	
	5	3.2-5	60	-8JU00	
	6.3	4-6.3	75	-2KU00	1035 2NC
	8	5-8	96	-8KU00	
	10	6.3-10	120	-2LU00	
	12	8-12.5	150	-8LU00	
	16	10-16	192	-2MU00	
	20	14-20	210	-2NU00	

DZ108(3VE) Moulded Case Circuit Breaker



Table 2

Type	Rated current (A)	Release Current Setting range(A)	Choices of auxiliary contacts (A)	Order No. Article No.	Auxiliary contacts
DZ108-32(3VE3)	1.6	1-1.6	19	3VE3000-2GA00	Special Order
	2.5	1.6-2.5	30	-2HA00	
	4	2.5-4	48	-2JA00	
	6.3	4-6.3	75	-2KA00	
	10	6.3-10	120	-3VE3000-2LA00	
	12.5	8-12.5	150	-8LA00	
	16	10-16	192	-2MA00	
	20	12.5-20	240	3VE3000-8MA00	
	25	16-26	300	-2NA00	
	32	22-32	380	-2PA00	
DZ108-63 DZ308-63 (3VE4、3VF1)	10	6.3-10	120	3VE4200-0CL00	Special Order
	16	10-16	192	-0CM00	
	25	16-25	300	-0CP00	
	32	22-32	380	-0CQ00	
	40	28-40	4980	-0CR00	
	50	36-50	600	-0CS00	
63	45-63	700	-0CT00		

DZ208(3VU) Moulded Case Circuit Breaker



Application

DZ208 series circuit breaker is new type breaker which introduce new design of Siemens, can replace the DZ108 (3VE) series. This series breaker compose DZ208-25(3VU13) and DZ208-63(3VU16), and is suitable for the circuit of 50/60Hz, rated insulation voltage 750VAC, rated working voltage 690VAC, rated current 0.1A-63A. It has the protection function such as over-load protection, short-circuit protection, and phase failure protection for motor, can be used as entire pressure starter for directly starting and breaking motor as well. It also can protect the circuit of rated current 0.1~63A.

Main Technical Parameters

DZ208-25(3VU13)

Table 1

Thermal overloading tripper		Instantaneous over current tripper		
Rated Current(A)	Motor output power	Commuting current range		Article No.
A	KW	A	A	
0.16		0.1-0.16	1.9	-1MB00
0.24	0.06	0.16-0.24	2.9	-1MC00
0.4	0.09/0.12	0.24-0.4	4.8	-1MD00
0.6	0.12/0.18	0.4-0.6	7.2	-1ME00
1	0.25	0.6-1	12	-1MF00
1.6	0.37/0.55	1-1.6	19	-1MG00
2.4	0.75	1.6-2.4	29	-1MH00
3.2	1.1	2-3.2	38	-1NH00
4	1.1/1.5	2.4-4	48	-1MJ00
005	1.5/2.2	3.2-5	60	-1NJ00
6	2.2	4-6	72	-1MK00
8	3	5-8	96	-1NK00
10	3/4	6-10	120	-1ML00
13	4/5.5	8-13	156	-1NL00
16	7.5	10-16	190	-1MM00
20	7.5	14-20	240	-1MN00
25	11	18-25	300	-1MP00

DZ208(3VU) Moulded Case Circuit Breaker



DZ208-63(3VU16)

Table 2

Thermal overloading tripper		45 Instantaneous over current tripper		
Rated Current(A)	Electric motor output power	Setting current range		Article No.
A	KW	A	A	
1.6	0.37/0.55	1-1.6	19	-1MG00
2.4	0.75	1.6	29	-1MH00
4	1.1/1.5	2.4	48	-1MJ00
6	2.2	2.4-4	72	-1MK00
		4-6		
10	34		120	-1ML00
16	5.5/7.5	6-10	190	-1MM00
25	11	10-16	300	-1MN00
		16-25		
32	15		380	-1MP00
40	18.5	22-23	480	-1MQ00
52	22	28-40	600	-1NR00
		36-52		
63		45-63	600	-1MS00

Characteristic curves

The characteristic curves shown here apply for a DZ208 circuit breaker with a rated current of 6A, a current setting range of 4 to 6A and a tripping current for the instantaneous overload release of 72A, at a rated voltage of AC 50Hz, 400V.

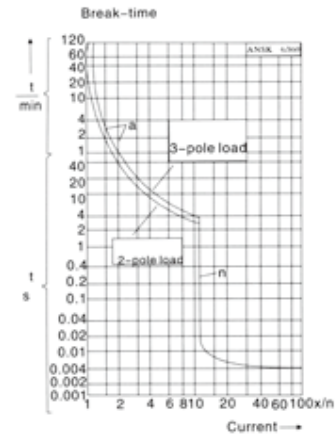

Schematic representation of the time/current characteristic for DZ208

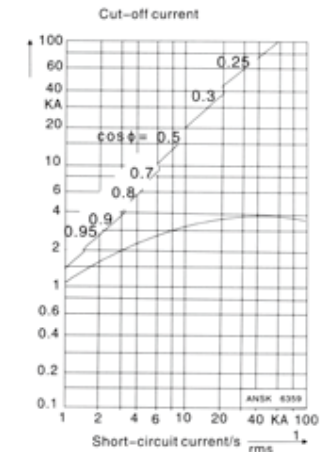

Current limiting characteristic for DZ208

DZ208(3VU) Moulded Case Circuit Breaker

DZ208-25(3VU13)

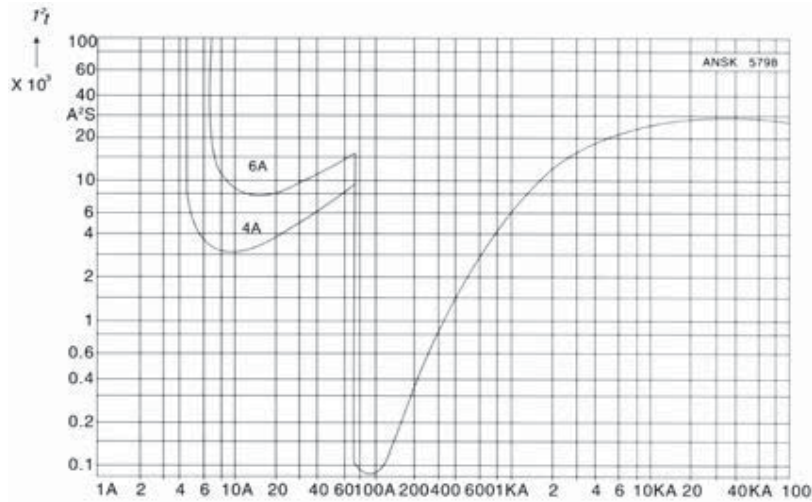

I²t characteristic for DZ208-25(3VU13)

Short-circuit current/s →

DZ208-63(3VU16)

The characteristic curves shown here apply for a DZ208-63(3VU16) circuit breaker with a rated current of 25A and a tripping current for the instantaneous over current trip of 300A, at a rated voltage of AC 50Hz, 400V.

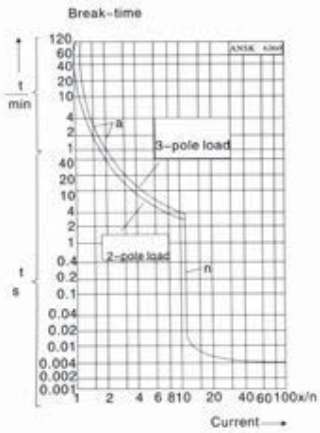

Schematic representation of the time/current characteristic for DZ208-63(3VU16)

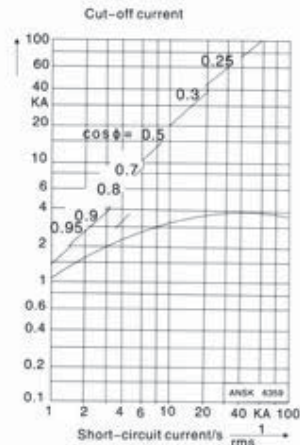

Current limiting characteristic for DZ208-63(3VU16)

DZ208(3VU) Moulded Case Circuit Breaker



DZ208-63(3VU16)

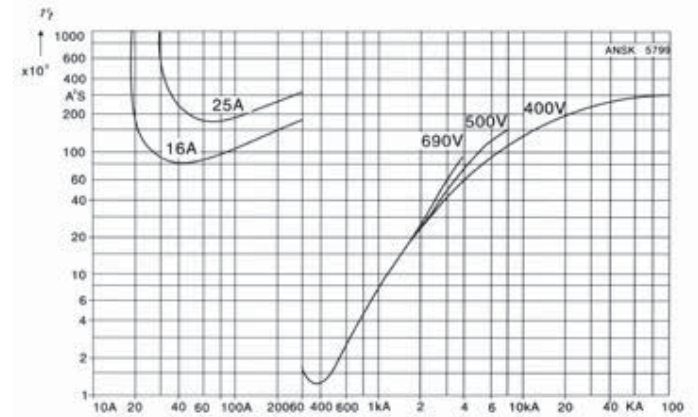

I²t characteristic for DZ208-63(3VU16)

Short-circuit current/s →

Equipment Circuit Diagrams

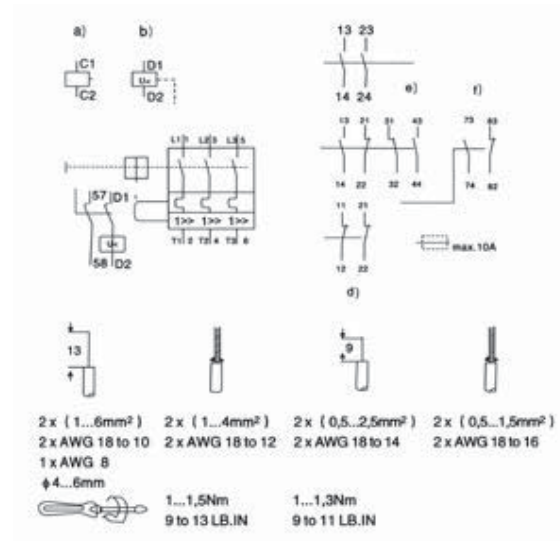

- a) Shunt trip
- b) Under voltage trip
- c) Under voltage with leading auxiliary contacts
- d) Auxiliary contacts
- e) Additional auxiliary contacts
- f) Short-circuit indicator

DZ518(GV2)



Application

DZ518 (GV1, GV2, GV3) series motor protection circuit breaker adopt modular design with feature as artistic outline, small volume, phase failure protection, built-in thermal relay, excellent performance, good generality. DZ518 series conform to standard: IEC 60947.2, IEC 60947-4.1 and EN60947.1 Switch and contactor can compose the direct starter for motor. The IP code of shell can reach IP65. This series have three model: DZ548(GV2-M, ME) is push button control motor breaker with thermal magnetic protection; DZ518(GV2-RS) is turn button control motor breaker with thermal magnetic protection. DZ518(GV2-LS, LE) is changeover switch control motor breaker with thermal protection (without thermal delay protection)

The Model No.and Meanig

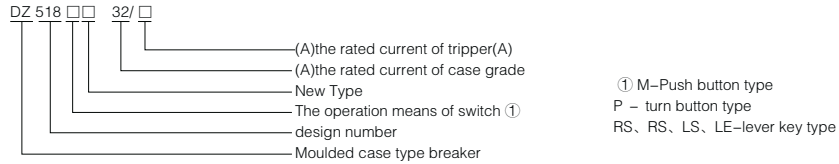

DZ518(GV2) Air switch of the motor

Table 1

DZ518(GV2-M) (ME)(P)	DZ518(GV2-RS)	DZ518(GV2-LS)(LE)
M01C 0.1-0.16	RS01C 0.1-0.16	
M02C 0.16-0.25	RS02C 0.16-0.25	
M03C 0.25-0.40	RS03C 0.25-0.40	LS03 0.25-0.40
M04C 0.40-0.63	RS04C 0.40-0.63	LS04 0.40-0.63
M05C 0.63-1	RS05C 0.63-1	LS05 0.63-1
M06C 1-1.6	RS06C 1-1.6	LS06 1-1.6
M07C 1.6-2.5	RS07C 1.6-2.5	LS07 1.6-2.5
M08C 2.5-4	RS08C 2.5-4	LS08 2.5-4
M10C 4-6.3	RS10C 4-6.3	LS10 4-6.3
M14C 6-10	RS14C 6-10	LS14 6-10
M16C 9-14	RS16C 9-14	LS16 9-14
M18C 10-16	RS18C 10-16	LS18 10-16
M20C 13-18	RS20C 13-18	LS20 13-18
M21C 17-23	RS21C 17-23	LS21 17-23
M22C 20-25	RS22C 20-25	LS22 20-25
M32C 24-32	RS32C 24-32	

The rated power of three-phase motor controlled by breaker(GV2 motor circuit breaker)

Table 2

The adjustable range of rated current i(e).	The standard power of three-phase motor KW.AC-3, 50HZ/60HZ						
	230/240V	400V	415V	440V	500V	690V	
0.1-0.16	-	-	-	-	-	-	
0.16-0.25	-	-	-	-	-	-	
0.25-0.4	-	-	-	-	-	-	
0.4-0.63	-	-	-	-	-	0.37	
0.63-1	-	-	-	0.37	0.37	0.55	
1-1.6	-	0.37	-	0.55	0.75	1.1	
1.6-2.5	0.37	0.75	0.75	1.1	1.1	1.5	
2.5-4	0.75	1.5	1.5	1.5	2.2	3	
4-6.3	1.1	2.2	2.2	3	3.7	4	
6-10	2.2	4	4	4	5.5	7.5	
9-14	3	5.5	5.5	7.5	7.5	9	
13-18	4	7.5	9	9	9	11	
17-23	5.5	11	11	11	11	15	
20-25	5.5	11	11	11	15	18.5	
24-32	7.5	15	15	15	18.5	23	

DZ518(GV2)



The instant electromagnet tripping current setting value of breaker.(Refer to table 3)

Table 3

Rated current InA	The adjustable range of setting current for thermal components A.	The setting value of instant electromagnet tripping current
0.16	0.1-0.16	1.5
0.25	0.16-0.25	2.4
0.4	0.25-0.4	5
0.63	0.4-0.63	8
1	0.63-1	13
1.6	1-1.6	22.5
2.5	1.6-2.5	33.5
4	2.5-4	51
6.3	4-6.3	78
10	6-10	138
14	9-14	170
18	13-18	223
23	17-23	327
25	20-25	327
32	24-32	416

Accessories(refer to table4)

Additional contacts

Table 4

Names of accessories	Code	Types of contacts	Installation place
Instantaneous auxiliary contacts	AE1	1NO/NC	The front of breaker (1PC can be installed)
	AE11	1NO+NC	
	AE20	2NO	The left of breaker (4PCS can be installed)
	AN11	1NO+1NC	
	AN20	2NO	
Fault signal contacts+Instantaneous auxiliary contacts	AD1010	Constant-open trouble	NO
	AD1001		NC
	AD0110	Constant-open trouble	NO
	AD0101		NC
Short circuit contacts	Am11	1NO, 1NC	

Electric tripper

Table 5

Names of accessories	Code	Voltage	Installation place
Under-voltage trip	AU115	110-127V 50Hz	The right of breaker (1PC can be installed)
	AU225	220-240V 50Hz	
	AU385	380-415V 50Hz	
Shunt trip	AS115	110-127V 50Hz	
	AS225	220-240V 50Hz	
	AS385	380-415V 50Hz	
Used for under-voltage trip for dangerous machine	AX115	110-127V 50Hz	
	AX225	220-240V 50Hz	
	AX385	380-415V 50Hz	

Electric tripper

Table 5

Names of accessories	The protection grade of case	Code	Memo
External installation shell	IP41	MC01	
	IP55	MC02	
	IP65	MC03	

DZ518(GV2)

The Outline Installation Dimension

The outline and installation dimension of breaker (GV2 Motor circuit breaker)(refer to picture 2,3)
 The breaker (GV2 Motor circuit breaker) adopts the standard Din-rail installation,the Din-rail rail should meet the A2.1TH35-7.5 type installation standard of JB6525.
 The external installation dimension of GV2 Motor circuit breaker(refer to picture 4,5)

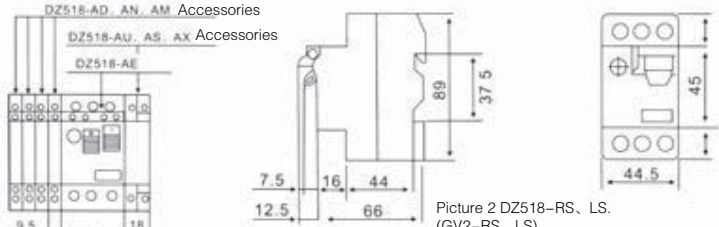

Picture 2 DZ518-RS, LS. (GV2-RS, LS)

Picture 4 DZ518-AN, AD, ..., AM, DZ518-AU, AS, AX, ..., DZ518-AE.

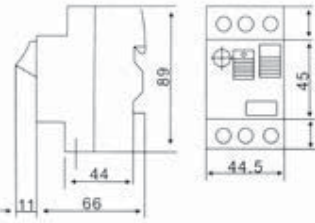

Picture 3 DZ518-M (GV2-M)

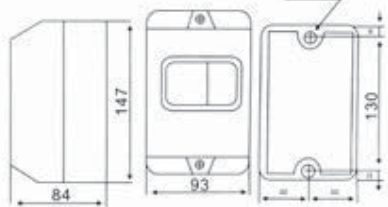

Picture 5 DZ518-MC(GV2-MC/GV4)

The characteristic curve of tripping(refer to picture 1)the average work time according to the multiple of setting current

- (1)Begin with cold state,3 poles
- (2)Begin with cold state,2 poles
- (3)Begin with hot state,3 poles

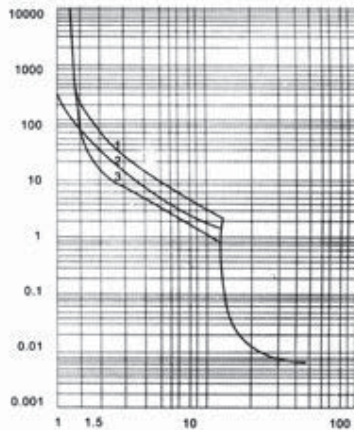

The hot magnetic disjoining curve of DZ518

DZ518(GV2)



Main Technical Parameters

1. Rated insulation voltage $U_i(V)$:690;
2. Rated work voltage $U_e(V)$:230/240、400/415、440、500、690;
3. Rated frequency Hz :50/60;
4. The rated current of shell grade $I_{nm}(A)$:32;
5. The rated voltage of tripper $I_n(A)$ (Table 1);
6. The adjustable range of setting current (A)(Table 1);
7. The breaking capacity for rated limiting short circuit $I_{cu}(kA)$ (Table 1);
8. The cutting capacity for rated work short circuit $I_{cs}(kA)$ (Table 1);
9. The rated impulse with stand voltage $U_{imp}(V)$

Table7

Rated current $I_n(A)$	The adjustable range of setting current	The breaking capacity for rated limiting short circuit I_{cu} ,The breaking capacity for rated work short circuit I_{cs}										The distance of flashover (mm)
		230/240V		400/415V		440V		500V		690V		
		$I_{cu}(kA)$	$I_{cs}(kA)$	$I_{cu}(kA)$	$I_{cs}(kA)$	$I_{cu}(kA)$	$I_{cs}(kA)$	$I_{cu}(kA)$	$I_{cs}(kA)$	$I_{cu}(kA)$	$I_{cs}(kA)$	
0.16	0.10-0.16	100	100	100	100	100	100	100	100	100	100	40
0.25	0.16-0.25	100	100	100	100	100	100	100	100	100	100	40
0.4	0.25-0.4	100	100	100	100	100	100	100	100	100	100	40
0.63	0.4-0.63	100	100	100	100	100	100	100	100	100	100	40
1	0.63-1	100	100	100	100	100	100	100	100	100	100	40
1.65	1-1.6	100	100	100	100	100	100	100	100	100	100	40
2.5	1.6-2.5	100	100	100	100	100	100	100	100	3	2.25	40
4	2.5-4	100	100	100	100	100	100	100	100	3	2.25	40
6.3	4-6.3	100	100	100	100	50	50	50	50	3	2.25	40
10	6-10	100	100	100	100	15	15	10	10	3	2.25	40
14	9-14	100	100	15	7.5	8	4	6	4.5	3	2.25	40
18	13-18	100	100	15	7.5	8	4	6	4.5	3	2.25	40
23	17-23	50	50	15	6	6	3	4	3	3	2.25	40
25	20-25	50	50	15	6	6	3	4	3	3	2.25	40
32	24-32	50	50	10	6	6	3	4	3	3	2.25	40

The characteristic of over-current action protection

The action characteristic of breaker(Gv2 Motor circuit breaker)when every phase load is in balance(refer to Table 8)

Table 8

The multiple of rated current	Starting state	Stipulated time	Due result	The temperature of ambient air
1.05	Cold state	$t \leq 2h$	No tripping	+40°C ± 2°C
1.2	Thermal state(rises up to the stipulated current after following the test of No 1)	$t < 2h$	Tripping	
1.5	Start after one time setting current thermal balance	$t < 2min$	Tripping	
7.2	Cold state	$2 < t \leq 10S$	Tripping	

The action characteristic of breaker(Gv2 Motor circuit breaker)when each phase load is in balance(phase-broken)

Table 9

The multiple of rated current		Starting state	Stipulated time	Due result	The temperature of ambient air
Any two phases	The third phases				
1.0	0.9	Cold state	$t \leq 2h$	No tripping	+40°C ± 2°C
1.15	0	Thermal state(rises up to the stipulated current after following the test of No. 1)	$t < 2h$	Tripping	

DZ518(GV3) Moulded Case Circuit Breaker



Application

DZ518 circuit breaker (GV3 moulded case type circuit breaker) is suitable for the circuit with voltage up to 690V, current 1~ 80A. It has the function such as over-load protection, phase failure protection, short-circuit protection for mouse cage type asynchronous motor and can also control the infrequent start of mouse cage type asynchronous motor. In addition, it can protect the distribution line, exchange the load infrequently, and serve as isolator.

The Model No.and Meaning

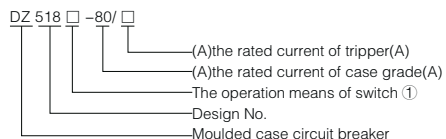

① M-Push button type ② ME-New type

Table 1

DZ518-M	(GV3-M)	(GV3-ME)
DZ518-M10	6-10A	6-10A
DZ518-M16	10-16A	10-16A
DZ518-M20	14-20A	14-20A
DZ518-M25	16-25A	16-25A
DZ518-M40	25-40A	25-40A
DZ518-M63	40-63A	40-63A
DZ518-M80	56-80A	56-80A

Type	The adjustable range setting current for components A.	The standard rated power of three-phase motor KW.AC-3, 50Hz/60Hz
	Amps	KW
DZ518-M40	25-40	18.5
DZ518-M63	40-63	30
DZ518-M80	56-80	40

DZ518M(GV3) Attachment

Names of accessories	Code	Types of contacts	Installation place	Memo
Instantaneous auxiliary contacts	A01	1NO+NC	The right of breaker	
	A02	2NO		

Overall and Mounting Dimensions

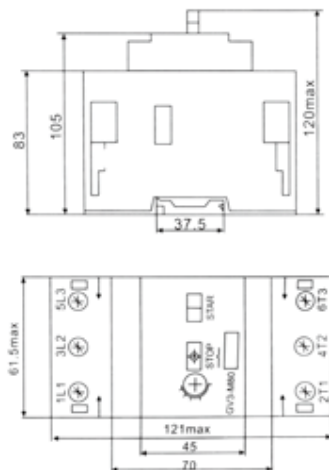

OM1 Moulded Case Circuit Breaker



Application

OM1 series moulded case circuit breakers is a new designed breaker, designed, developed and manufactured adopting international advanced technology. The rated insulating voltage AC800V, is suitable for using in the circuit of AC50, rated voltage up to 690V and below, rated working current up to 800V for infrequently switching and starting of motor and for protecting motor from overload, short current and undervoltage and circuit and power supply equipment from damage.

Working Condition

1. Not over altitude 2000m
2. Ambient temperature is between -5°C to +40°C
3. Withstand the influence of moist air;
4. Withstand the influence of smoke fog, salt mist;
5. Withstand the influence of fungus;
6. The max.gradient is 22.5;
7. Working reliably under the condition of normal vibration in ship;
8. Working reliably under the condition of earth quake(4g);
9. Working in the medium which not any explosive, no enough dielectric to corrode metal, no gas to damage insulation and electric conduction dust.
10. Working in the place would not be invaded by rain and snow.

The Model No.and Meaning

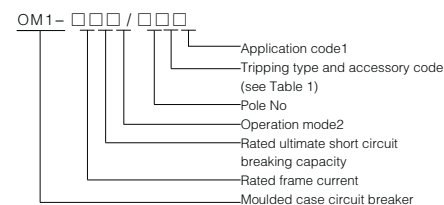

- Note: 1.No code for current distribution; 2 for motor protection;
2.No code for operating directly with handle, "P" for power-driven and Z for turning handle manually.

Classification

1. According to the pole number of products, it class two-pole (100A, 225A) three-pole (no four-pole for OM1-800), the neutral pole (N-pole) of the four-pole breakers has four types: Type A: N-pole without over-current release unit, it has been connected all along, and does not act with other three-pole to turn on or off. Type B: N-pole without over-current release unit, it could act with other three-pole (N-pole turn-on prior to turn-off); Type C: N-pole fixed with over-current release unit, it could act with other three-pole (N-pole turn-on prior to turn-off); Type D: N-pole fixes with over-current release unit, it has been connected all along, and does not act with other three-pole to turn on and off.
2. According to rated current of products, it classifies: OM1-63: (6), 10A, 16A, 20A, 25A, 32A, 40A, 50A, 63A, (no over-load protection for 6A); OM1-100: (10), 10A, 16A, 20A, 25A, 32A, 40A, 50A, 63A, 80A, 100A; OM1-160: 100A, 125A, 140A, 160A; OM1-225: 100A, 125A, 140A, 160A; OM1-400: 225A, 250A, 315A, 350A, 400A; OM1-630: 400A, 500A, 630A; OM1-800: 630A, 700A, 800A;
3. According to connection mode, it classifies front in wiring, rear in wiring, and plug in type.
4. According to over-current release type, it classifies the thermodynamic-magnetic (binary) type and magnetic (instantaneous) releases

For example:

1. If place an order for OM1-100M, three-pole, for motor protection, rates current 80A, with shunt release and auxiliary contact, front in wiring, mechanical interlock between two breaker, if would be written as "To order OM1-100M/33402, In=80A, front in wiring, mechanical interlock between two pcs, release coil voltage is AC220V."
2. If place an order for OM1-225, four-pole, for power distribution, rated current 180A with motor operation mechanism and shunt release, N-pole fixed with over current release and could act with other three pole, rear in wiring, ten pcs, it would be written as "To order OM1-225P3410 type C, In=180A, rear in wiring, ten breakers, motor operating voltage 200V, release coil voltage: 220V".

Fast Selection Table for OM1 Series Moulded Case Circuit Breakers

For fast selection, see following Table 1 please:

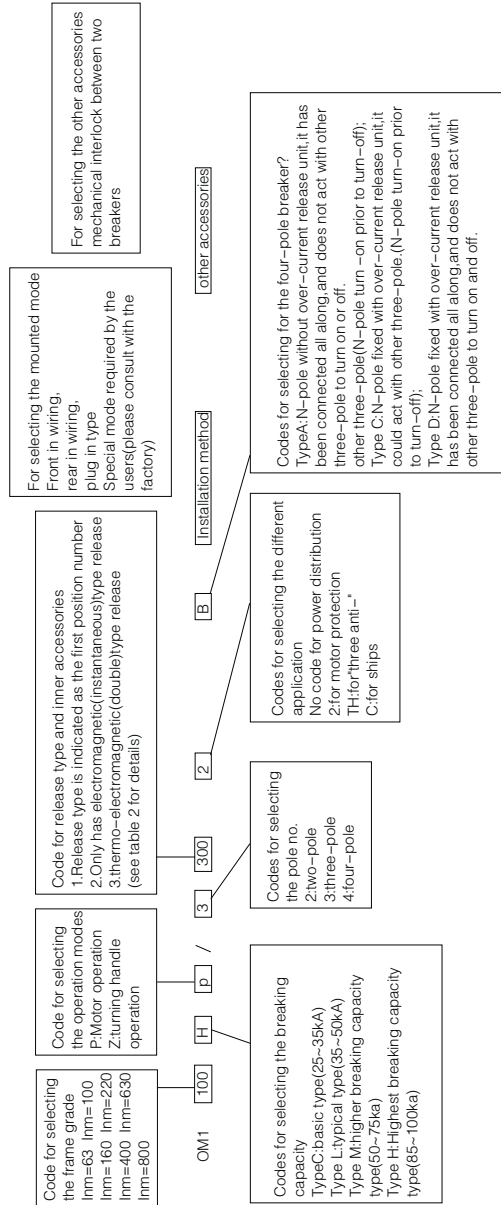

OM1 Moulded Case Circuit Breaker



Protective Characteristics

The thermodynamic of a circuit breaker provides the feature of inverse time-delay, while the magnetic release the instantaneous operation as shown on Table 2 (distribution circuit breaker) and Table 3 (motor protection circuit breaker):

Table 2 (for distribution)

Rated current of release	Thermodynamic release (ambient temp: land +40°C, marin +45°C)		Electromagnetic release action current (A)	(A) Rated current of release	Thermodynamic release (ambient temp: land +40°C, marin +45°C)				Rated current of release (A)
	1.0In (Coldstate) Non-action time (h)	1.20In (Hotstate) Action time			1.50In (Hotstate) Action time	7.2In (coldstate) Action time			
10 ≤ In ≤ 63	1	1	10In ± 20%	10 ≤ In ≤ 255	2	2	4min	4 < Tp ≤ 10S	12In ± 20%
63 ≤ In ≤ 100	2	2					8min	6 < Tp ≤ 20S	
100 ≤ In ≤ 800	2	2	5In ± 20% 10In ± 20%	225 < In ≤ 800					

Main Technical Parameters

See Table 4

Model	Rated frame current	rated current	rated working voltage	rated insulated voltage	Rated ultimate short-circuit breaking KA 400v capacity	Rated running breaking capacity kA 400v	overall dimension			Mounting dimension (front in wiring)		
							L	W 3P/4P	H	A	B	4-Φd
OM1-63L	63	(6)、10、16、20、	AC400V	AC500V	25	18	135	78	73.5	25	117	Φ3.5
OM1-63M		25、32、40、50、63			50	35	135	78/103	81.5			
OM1-100L	100	(10)、15、20、25、	AC690V	AC800V	35	22	150	92	68	30	129	Φ4.5
OM1-100M					50	35	150	92/122	86			
OM1-100H		100			85	50						
OM1-160L	160	100、125、140、160	AC690V	AC800V	35	22	165	107	86	35	126	Φ4.5
OM1-160M					50	35	165	107/142	103			
OM1-160H					85	50						
OM1-225L	225	100、125、140、	AC690V	AC800V	35	22	165	107	86	35	12	Φ4.5
OM1-225M					50	35	165	107/142	103			
OM1-225H					85	50						
OM1-400L	400	225、250、315、	AC690V	AC800V	50	35	275	150/198	105	44	194	Φ7
OM1-400M					65	42	275	150	105.5	44	194	Φ7
OM1-400H		350、400			100	65						
OM1-630L	630	400、500、630	AC690V	AC800V	50	35	270	182/240	110	58	200	Φ7
OM1-630M					65	42	270	182	110			
OM1-630H					100	65	275	210	115.5	70	243	Φ7
OM1-800M	800	630、700、800	AC690V	AC800V	75	50	275	210	115.5	70	243	Φ7
OM1-800H					100	65						

See Table 5 for sectional area of connecting conductor and the proper rated current:

Rated current value	10	16.20	25	32	40.50	63	80	100	125	160	180,200,225	250	315,315	400
Cable(mm ²)	1.5	2.5	4	6	10	16	25	35	50	70	95	120	185	240

Table 5

Rated current value	Copper row		Sectional Area	
	Cable(mm ²)	Quantity	Dimension	Quantity
500	150	2	30×5	2
630	185	2	40×5	2
700,800	200	2	40×5	2

OM1 Moulded Case Circuit Breaker

Overall and Mounting Dimensions

OM1-160(L, M, H) plug in wiring dimension(three-pole ,four-pole)X-Y three-pole breaker center

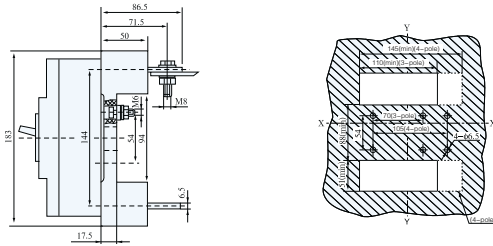

OM1-225(L, M, H) front in wiring dimension(three-pole ,four-pole)X-Y three-pole breaker center

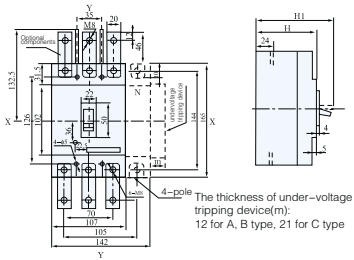

Front in wiring mounting plate aperture dimension

OM1-225(L, M, H) rear in wiring dimension(three-pole ,four-pole)X-Y three-pole breaker center

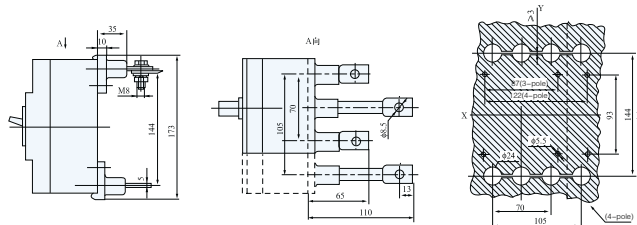

Rear in wiring mounting plate aperture dimension

OM1-225(L, M, H) plug in wiring dimension(three-pole ,four-pole)X-Y three-pole breaker center

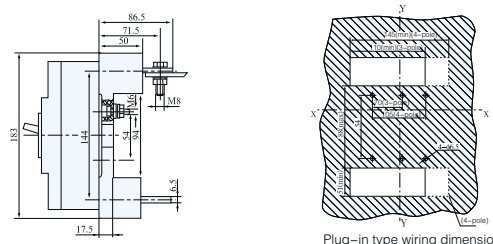

Plug-in type wiring dimension

OM1 Moulded Case Circuit Breaker



Overall and Mounting Dimensions

OM1-400(L, M, H) Front in wiring dimension(three-pole ,four-pole)X-Y three-pole breaker center

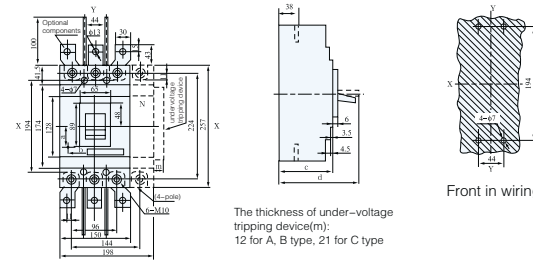

The thickness of under-voltage tripping device(m):
12 for A, B type, 21 for C type

Front in wiring mounting plate aperture dimension

Model	a	b	c	d
OM1-400L	43	57	105	155
OM1-400H	29.2	57	106.5	146.5
OM1-400M				

OM1-400(L, M, H) rear in wiring dimension(three-pole ,four-pole)X-Y three-pole breaker center

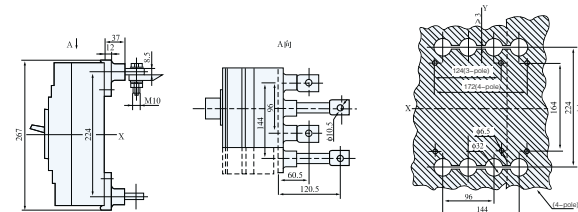

Rear in wiring mounting plate aperture dimension

OM1-400(L, M, H) plug in wiring dimension(three-pole ,four-pole)X-Y three-pole breaker center

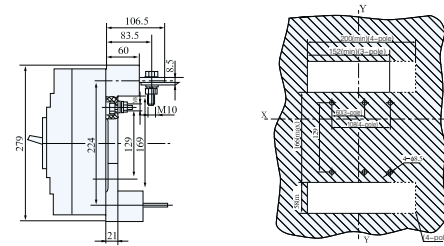

Plug-in type wiring dimension

OM1-630(L, M) front in wiring dimension(three-pole ,four-pole)X-Y three-pole breaker center

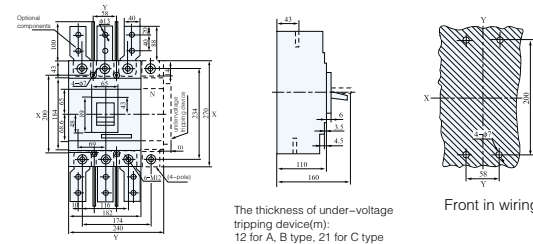

The thickness of under-voltage tripping device(m):
12 for A, B type, 21 for C type

Front in wiring mounting plate aperture dimension

OM3 Moulded Case Circuit Breaker

Categories

- By the use of sub-circuit breakers: distribution protection type; motor protection type;
- By Connection points: pre-wiring board, board, after wiring, insert, extract-type wiring;
- According to mode of operation hours: Handle direct operation, the external switch to hands-on operation, electric operation;
- Press Release and sub-type: only instant action tripper (electromagnetic tripper), thermal dynamic+electromagnetic tripper (double);
- Four-pole circuit breaker, the neutral pole (N type) There are six types:
- A Type: N pole is not installed over-current trip device, and the N pole is always connected with the non-polar with the other three combined points;
- B-: N pole is not installed over-current trip device, and N, and, together with the other three co-polar points;
- C-: N pole installed, the current trip device, and the N pole, together with the other three co-polar points;
- D-: N pole installation of over-current trip device, and the N pole is always connected with the non-polar with the other three combined points;
- E-type: N pole mounted off the neutral line of the first protector, and the N pole, together with the other three co-polar points;
- F-: N pole mounted Neutral wire protector, and the N pole is not always connected with the other are those charged with the co-points;
- Set points in Annex: with the subsidiary unit, without the subsidiary unit.

Tripper way and ancillary devices, code-named in Table1

Annex code	Attachment Name	Model	OM3-135 OM3-160	OM1-250 OM1-400	OM1-630 OM1-800
		Pole	3,4	3,4	3,4
200, 300	Subsidiary device without				
208, 308	Alarm contact				
210, 310	SHT device				
220, 320	Auxiliary contact				
230, 330	Undervoltage trip device				
240, 340	SHT device Auxiliary contact				
260, 360	2 auxiliary contact group				
270, 370	Auxiliary contact Under-voltage device off voltage				
218, 318	SHT device Alarm contact				
228, 328	Auxiliary contact Alarm contact				
238, 338	Undervoltage trip device Alarm contact				
248, 348	SHT device Auxiliary contact Alarm contact				
268, 368	2 auxiliary contact group Alarm contact				
278, 378	Auxiliary contact Under-voltage device off voltage Alarm contact				

The left side install The right side install

- Alarm contact
- Auxiliary contact
- SHT device
- Under-voltage device off voltage
- Lead direction

OM3 Moulded Case Circuit Breaker



The Model No. and Meaning

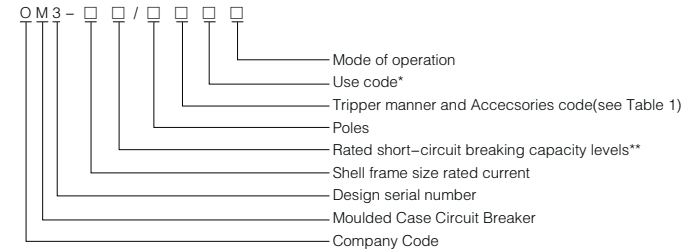

- *1. Switchboard with circuit breakers without code; motor protection type is "2"
- 2. Handle direct manipulation-free code; electric operation to P, said: external turning operation to Z, said handle;
- **Rared short-circuit breaking capacity level: E-economy; S-Standard; M-breaking type of high scores; H-scores-off type; L-current-limiting type.

Circuit breaker main technical performance indicators

Model	OM3-125	OM3-160	OM3-250	OM3-400	OM3-630	OM3-800	
Rated Current	12.5, 16, 20 25, 32, 40, 50 63, 80, 100, 125	16, 20, 25, 32 40, 50, 63, 80 100, 125, 160	100, 125, 160 180, 200, 225 250	200, 225, 250 315, 350, 400	400, 500, 630	500, 630, 700, 800	
Pole	2, 3, 4	2, 3, 4	2, 3, 4	2, 3, 4	2, 3, 4	2, 3, 4	
Rated insulation voltage	690	690	690	690	690	690	
Rated voltage	380(400) 660(690)	380(400) 660(690)	380(400) 660(690)	380(400) 660(690)	380(400) 660(690)	380(400) 660(690)	
Number of operation	Power	3000	4000	2000	1000	1000	
	No power	7000	6000	6000	4000	4000	
Breaking capacity rating	E S M H S H L S M H L S M H L S M H S M H						
Limit short-circuit breaking capacity	AC400V	15 25 35 50	35 50 80	35 50 65 85	35 50 65 85	50 65 80	50 65 80
	AC690V	/ / 8 10	8 10 / 10	16 18 20 16 20	25 25 20 25	30 20 25 30	20 25 30
	DC250V	/ 20 20 40	20 40 40	40 40 40 40	40 40 40 40	40 40 40	40 40 60
Run short-circuit breaking capacity	AC400V	7 16 25 42	18 42 50	18 30 48 60	18 30 48 60	30 48 60	30 48 60
Dimensions	L	120	120	170	254	268	268
	W(3P/4P)	76/101	90/120	105/140	140/184	210/280	210/280
	H	70 80	70 80	101.5	101.5	101.5	101.5
Installation dimensions	A(3P/4P)	25/50	30/60	35/70	43.75 x 87.5	70/140	70/140
	B	100	100	139	214	237	237
	Φd	Φ4.5	Φ4.5	Φ5.5	Φ5.5	Φ5.5	Φ5.5

OM3 Moulded Case Circuit Breaker

And temperature rise test current (circuit breaker rated current) standards of the corresponding cross-sectional area of copper wire in Table 3

Cross-sectional of copper wire mm ²	2.5	4	6	10	16	25	35	50	70	95	120	185	240
Test Current A	12.5 20	25	32	40 50	63	80	100	125	160	200 225	250	315 350	400

Cross-sectional of copper wire mm ²	Wire copper	150	2 Root	185	2 Root	240	2 Root
Area mm x mm	Copper	30 x 5	2 Root	40 x 5	2 Root	50 x 5	2 Root
Test Current A		500		630		700 800	

OM3 series of quick selection table MCCB

Shell Frame size selectable current Inm=125 Inm=160 Inm=250 Inm=400 Inm=630 Inm=800	Rated current optional code OM3-125:12.5,16,20,25,32,40,50,63,80,100,125A OM3-160:16,20,25,32,40,50,63,80,100,125,160A OM3-250:100,125,160,180,200,225,250A OM3-400:200,225,250,315,350,400A OM3-630:400,500,630A OM3-800:500,630,700,800A	The election code for different purposes Distribution-free code"2"motor with protection	4 circuit breaking optional Model code A Type:N pole is not installed over-current trip device, and the N pole is always connected with the non-polar with the other three combined points; B--N pole not to install over-current trip device, and the N pole, together with the other three co-polar points; C--N pole to install over-current trip device, and the N pole, together with the other three co-polar points; D--N pole installation of over-current trip device, and the N pole is always connected with the non-polar with the other three combined points; E-type:N pole mounted Neutral wire protector, and the N pole, together with the other three co-polar points; F:N pole mounted Neutral wire protector, and the N pole is always connected with the non-polar with the other three combined points;
---	--	--	---

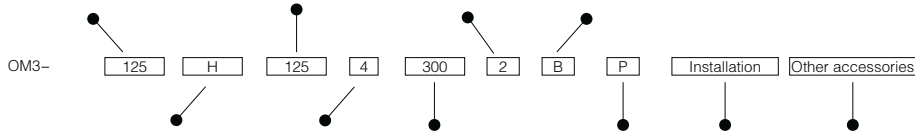

Optional code breaking capacity OM3-125 E.S.M.H OM3-160 S.H.L OM3-250 S.M.H.L OM3-400 S.M.H.L OM3-630 S.M.H OM3-800 S.M.H 1.OM3-125:E=15KA,S=25KA,M=35KA,H=50KA 2.OM3-160:S=35KA.H=50KA.L=80KA 3.OM3-250(400) S=35KA.M=50KA.L=80KA 4.OM3-630(800) S=50KA.M=65KA.H=80KA	Number of poles optional code 2:two pole 3:three pole 4:four pole Four-pole circuit breaking with breaking capacity of each shell frame H level appears	Tripper optional accessories such manner and within the first digital code,said tripper by: "2"only electromagnetic (instantaneous) tripper "3"Thermal-electromagnetic (Duplex) tripper Table 1	Optional mode of operation, code named Pelectric operation Z turn handle operation	Installation options Pre-wiring board After the wiring board Plug-in With drawable Grind-in:OM3-160,250,400,3P Out od style:OM3-4004P,630,800,3P,4P	Other attachments optional two sets of mechanical connection between the circuit breaker
--	--	--	--	---	--

OM3 Moulded Case Circuit Breaker



Circuit breaking installed safe distance

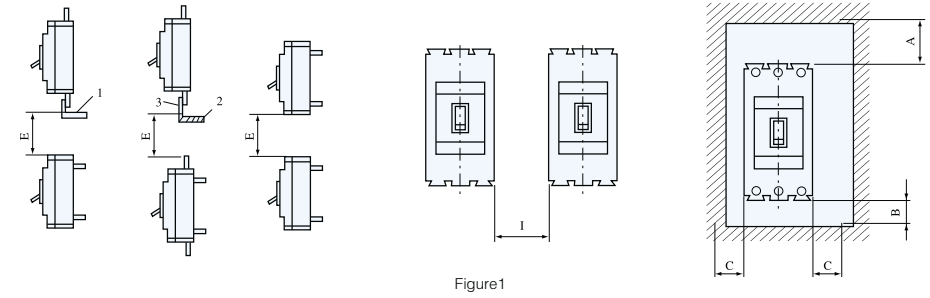

Breaker intallation of a safe distance from Table 5

Breaker Model	I	A	B	C	E
OM3-125.H OM3-160L	30	50	20	25	50
OM3-125.E.S	Can close to be	30	20	25	30
OM3-160.S.H		30	20	25	50
OM3-250		30	20	25	60
OM3-400		30	20	25	60
OM3-630.800		30	20	25	80

Circuit breaker Tripping characteristics

Circuit breaker overload delay(anti-time)protection features
Distribution protective overload circuit breaker time-lapse feature in Table 6

Rated Current(A)	1.05In agreed not to trip time(initial state:cold state)h	1.30In agreed not to trip time (initial state :thermal)h
≤ 63	≥ 1	< 1
> 63	≥ 2	< 2

motor Protection Circuit Breaker features overload time-lapse in Table 7

Test Current	Integer multiples of constant current	The appointed time 12.5A ≤ In ≤ 400A	Initial State
Agreed no to trip current	1.0	≥ 2h	cold state
	1.2	< 2h	thermal state
Trip current agreement	1.5	≤ 4min	cold state
	7.2	2S < Tp ≤ 10S	thermal state

Circuit Breaker short-circuit protection(instantaneous trip device)setting the value in Table 8

Shell Frame rating current (A)	Rated current(A)	Trip Current Setting the value of Ir(A)	
		Distribution Protection	Motor Protection
125	12.5,16,20,25,32,40,50	500	500
160	63,80,100,125,160	10In	12In
250	100,125,160,180,200,225,250	10In	12In
400	200,225,250,315,350,400	51In~10In*	12In
630	400,500,630	51In~10In*	
800	500,630,700,800	51In~10In*	

*According to user needs in this context setting

OM3 Moulded Case Circuit Breaker

Circuit Breaker Dimensions and Installation Dimensions

Fixed ,pre-wiring board` appearance and installation dimension shown in Figure 2 and Table 9

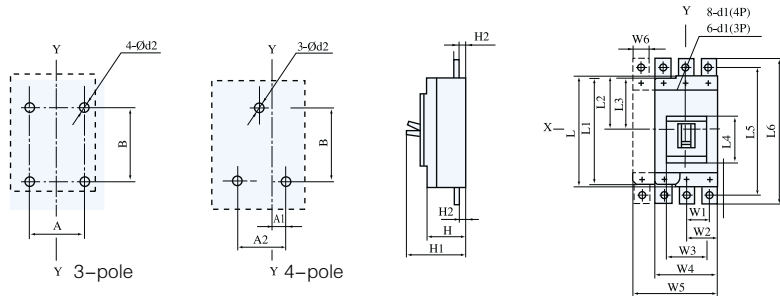

Table 9

Code Model	W1	W2	W3	W4	W5	W6	L	L1	L2	L3	L4	L5	L6	H	H1	H2	A	A1	A2	B	d1	Ød2
OM3-125E.S	25	38	76/101	76	101	14	125	120	74.5	72	45	150	166	70	91	25.5	25	12.5	50	100	M8	4.5
OM3-125M.H	25	38	76/101	76	101	14	125	120	74.5	72	45	150	166	80	101	35.5	25	12.5	50	100	M8	4.5
OM3-160L	30	45	90/150	90	120	14	125	120	74.5	72	45	150	166	80	103	37.5	30	15	60	100	M8	4.5
OM3-160S.H	30	45	90/150	90	120	14	125	120	74.5	72	45	150	166	70	93	27.5	30	15	60	100	M8	4.5
OM3-250	35	52.5	105/140	105	140	20	175	170	89.75	87.25	105	210	235	101.5	135	25	35	17.5	70	139	Ø8.5	5.5
OM3-400	43.785	70	105	140	183.75	25	259	254	127.75	125.25	105	285	330	101.5	135	25	34.75	22	87.5	214	Ø10.5	5.5
OM3-630	70	105	140	210	280	40	273	268	127.75	125.25	105	329	365	101.5	167.5	41.5	70	35	140	237	Ø10.5	5.5
OM3-800	70	105	140	210	280	40	273	268	127.75	125.25	105	329	365	101.5	167.5	41.5	70	35	140	237	Ø10.5	5.5

Fixed ,plate appearance after the wiring and installation dimensions shown in Figure 3 and Table 10

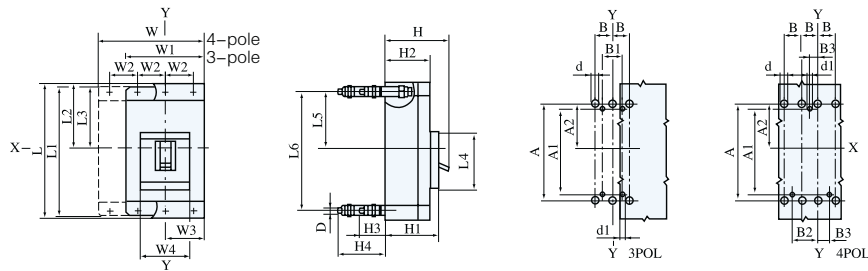

Table 10

Code Model	W	W1	W2	W3	W4	L	L1	L2	L3	L4	L5	L6	H	H1	H2	H3	H4	B	B1	B2	B3	A	A1	A2	d	d1	D
OM3-125E.S	101	76	25	38	76	125	120	74.5	72	45	63	102	91	75	70	42	75	25	25	37.5	12.5	12.5	100	63	Ø18	Ø4.5	M8
OM3-125M.H	101	76	25	38	76/101	125	120	74.5	72	45	63	102	101	85	80	42	75	25	25	37.5	12.5	102	100	63	Ø18	Ø4.5	M8
OM3-160L	120	90	30	45	90/120	125	120	74.5	72	45	63	102	103	85	80	42	75	30	30	45	45	102	100	63	Ø18	Ø4.5	M8
OM3-160S.H	120	90	30	45	90/120	125	120	74.5	72	45	63	102	93	75	70	42	75	30	30	45	15	102	100	63	Ø18	Ø4.5	M8
OM3-250	140	105	35	52.5	105/140	175	170	89.75	87.25	105	73.75	143	135	103.5	101.5	55	1000	35	35	52.5	17.5	143	139	73.75	Ø24	Ø5.5	M12
OM3-400	183.75	140	43.75	70	105	259	254	127.75	125.25	105	107.25	218	135	103.5	101.5	62	108	43.75	43.75	65.5	22	218	214	107.25	Ø24	Ø5.5	M12
OM3-630	180	210	70	105	140	273	268	127.75	125.25	105	117.75	241	167.5	103.5	101.5	68	68	70	70	105	35	241	237	111.75	Ø50	Ø5.5	M24
OM3-800	180	210	70	105	140	273	268	127.75	125.25	105	117.75	241	167.5	103.5	101.5	68	68	70	70	105	35	241	237	111.75	Ø50	Ø5.5	M24

OM3 Moulded Case Circuit Breaker



Plug-in , plate appearance before the wiring and installation dimensions shown in Figure 4 and Table 11.

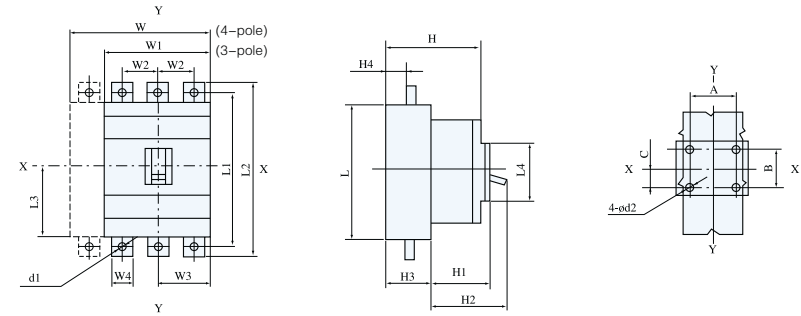

Table 11

Code Model	W	W1	W2	W3	W4	L	L1	L2	L3	L4	H	H1	H2	H3	H4	A	B	C	d1	d2
OM3-125E.S	101	76	25	38	14	164	192	208	71	45	123	75	91	52	25	50/75	35	5.5	M8	4.5
OM3-125M.H	101	76	25	38	14	164	192	208	71	45	133	85	101	52	25	50/75	35	5.5	M8	4.5
OM3-160S.H	120	90	30	45	14	164	192	208	71	45	123	75	93	52	25	60/90	35	5.5	M8	4.5
OM3-160L	120	90	30	45	14	164	192	208	71	45	133	85	103	52	25	60/90	35	5.5	M8	4.5
OM3-250S.M.H.L	140	105	35	52.5	20	175	210	230	85.25	105	153	103.5	135	52	31	70/105	100	47.75	Ø8	5
OM3-400S.M.H.L	/	140	43.75	70	25	259	305	333	131.25	105	153	103.5	135	52	31	115	135	67.25	Ø10.5	5.5

Fixed ,plate appearance after the wiring and installation dimensions shown in Figure 5 and Table 32

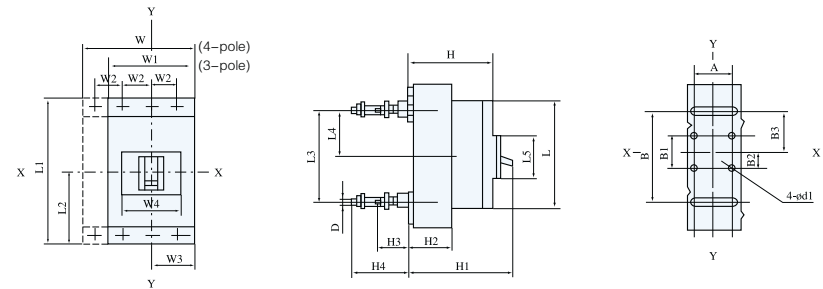

Table 12

Code Model	W	W1	W2	W3	W4	L	L1	L2	L3	L4	L5	H	H1	H2	H3	H4	A	B	B1	B2	B3	B4	B5	B6	B7	B8	B9
------------	---	----	----	----	----	---	----	----	----	----	----	---	----	----	----	----	---	---	----	----	----	----	----	----	----	----	----

OM3 Moulded Case Circuit Breaker

OM3-630,800 out of style(CH-1) after the connection plate dimensions and installation dimensions shown in Figure 6

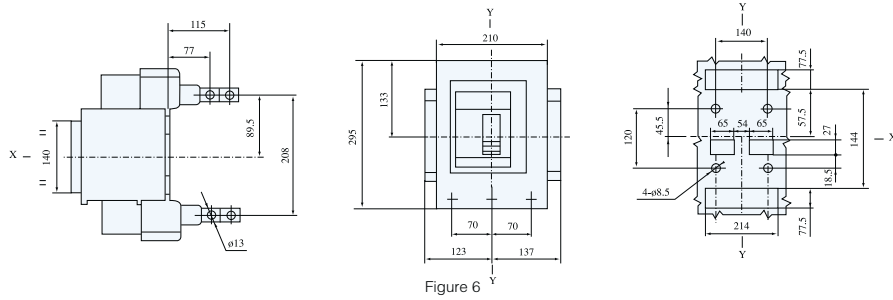

Figure 6

OM3-630,800 out of style(CH-1) plate before the next dimension and installation dimensions (3-pole) shown in Figure 7

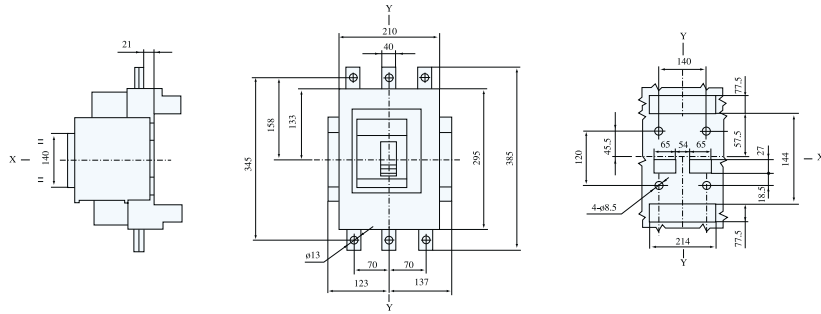

Figure 7

OM3-630,800 out of style(CH-1) after the wiring board dimensions and installation dimensions shown in Figure 8

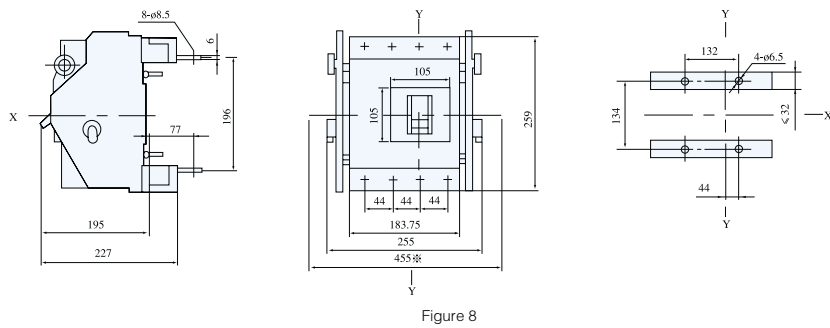
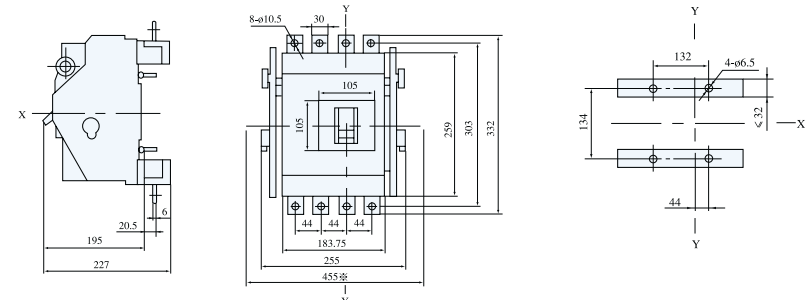

Figure 8

OM3 Moulded Case Circuit Breaker



OM3-400 4 pole cut of style (CH-2) plate pre-wiring and installation dimensions shown in Figure 9



Note:with a ※ symbol size drawer operation space size

OM3-630,800 out of three pole-type (CH-2) after the wiring plate dimension and installation dimensions shown in Figure 10

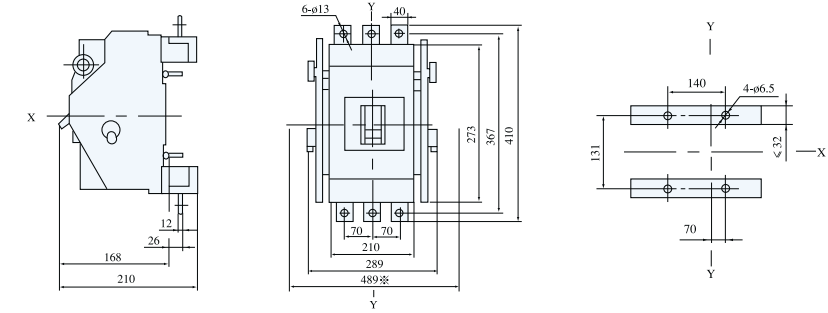

Note:with a ※ symbol size drawer operation space size

OM3-630,800 three-pole out of style (CH-2) plate pre-wiring and installation dimensions dimensions and installation dimensiond shown in Figure 11

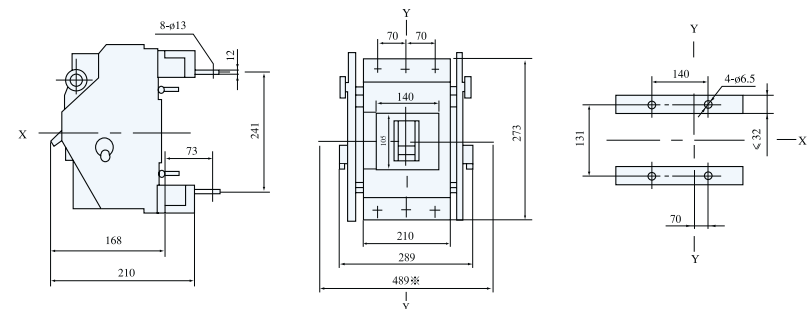

Note:with a ※ symbol size drawer operation space size

OM3 Moulded Case Circuit Breaker

OM3-600,800 four-pole out of style(CH-2) after the wiring plate dimensions and installations shown in Figure 12

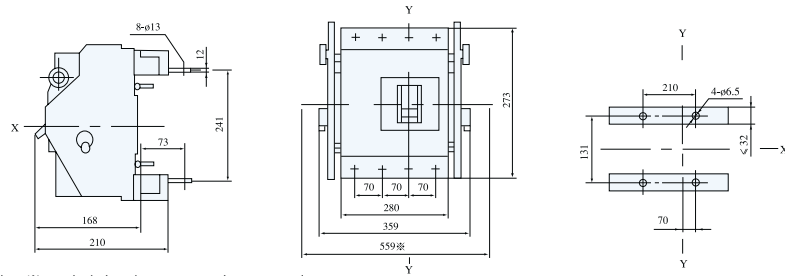

Note:with a ※ symbol size drawer operation space size

OM3-630,800 when the pole out of style(CH-2) plate pre-wiring and installation dimensions shown in Figure 13

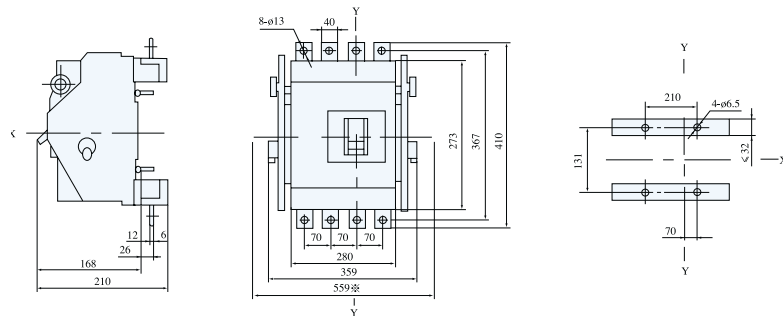

Note:with a ※ symbol size drawer operation space size

Internal circuit breaker sub unit

Circuit breaker cover within the sub device installed in the cavity,so easy to install,safe and reliable.

STH device wiring diagram (virtual box for switch internal attachment)

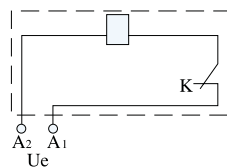

Under-voltage tripping device wiring diagram (virtual box for switching the internal attachment)

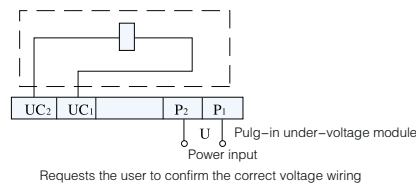

K:SHT inner coil in series with the micro-switch normally closed contact ,when the circuit breaker late,the contact self-disconnect when closing closure.Specifications :AC 50Hz,220V or 380V; DC 110V,24V at rated control supply voltage between 70~110% when the devices should be reliable SHT to circuit breaker tripping.

OM3 Moulded Case Circuit Breaker



Undervoltage tripping devices,sub-tripper of the ratings in table 13

Table 13

Model	SHT device			Under-voltage trip device		
	Rated voltage(V)	Rated Operating Current(A)	Rated Power(VA)	Rated voltage(V)	Rated Operating Curren (A)	Rated Power
OM3-125,160	AC220	1.1	242	AC220	4.2	0.91
	AC380	0.55	206	AC380	3	1
	DC110	4.5	484			
OM3-250,400	DC24	3	72	AC220	6	1.3
	AC220	1.2	260	AC380	4.5	1.6
	AC380	0.7	249			
OM3-630,800	DC24	8	192	AC220	5.5	1.2
	AC220	0.5	110	AC380	3.5	1.3
	AC380	0.3	140			
	DC24	4	96			

Note:The plug-in under-voltage module is only MO3-(125,160);other non-hanging modular wiring with a direct connection cited; Rated working voltage of 70%~35%,the under-voltage circuit breaker tripper to Talk to be reliable. Cautioned:under-voltage tripping device must be power,circlit breakers in order to re-buckle,and switch on,or they will damage switch!

cautioned users:circuit breakers within the sub unit is installed,the factory to ensure quality through plant commissioning,such as user purchased on their own within the sub unit,causing adverse peril.

Auxiliary contact

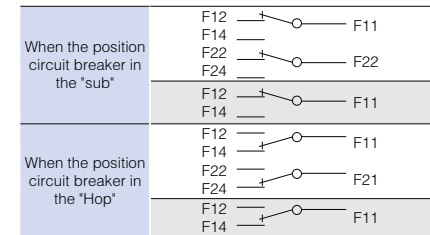

Auxiliary contact rated current in Table 14

Table 14

Shell Frame size rated current A	Convention heating current(Ith) A	AC 400V when the rated operating current(Ie) A
≤ 250	3	0.3
≥ 400	6	0.4

Circuit breaker in the 'sub' and 'closing'the position	Location of circuit breaker in the 'free trip' (alarm)
B12 B14	B12 B14
B12 B14	B12 B14

Circuit breaker outside the subsidiary devices

Rotating handle operating mechanism

For OM3 series of circuit breakers, by turning the handle to achieve complete device (drawer cabinets,distributionn boxes,power boxes,etc.) to operate in the panel request and to ensure that circuit breaker is closing,the cabinet door can not be opened(ie door interlock):only the operating handle is in " OFF" or Rest" (another button,the switch plate to open the door,when an emergency situation,circuit breakers need to open the door is closing,it can seat while pressing the handle on the red release button.

OM3 series models use the rotation handle CS3-type and CZ2 two kinds.

Motor operating mechanism

Electrical circuit breaker operating mechanism is to make long-distance component parts used auto-Hop sub-circuit breakers,the electrical operating mechanism points:CD2-type and CDtype.

CD2 electric operating mechanism

CD2 electric operating mechanism is a small permanent magnet DC motor drives.It has compact structure,small volume,easy installation and reliability,AC,DC General,you can use the handle for maunal operation,its mechanical life,electrical life and the same circuit breaker.

OM3 Moulded Case Circuit Breaker

Mechanical interlock between two circuit breakers shown in Figure 14 and Table 15

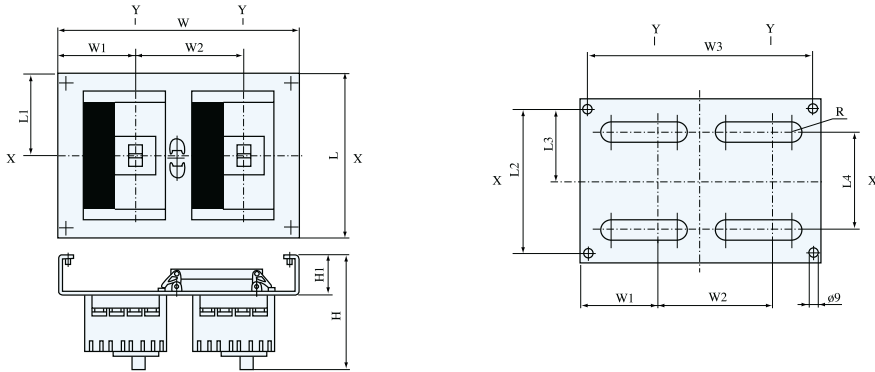

Model	Code	L	L1	L2	L3	L4	W	W1	W2	W3	H	H1	R
OM3-125		170	98.5	140	70	102	310	102	131	225	147	50	/
OM3-160		170	98.5	140	70	102	320	100	150	230	147	50	/
OM3-250		265	132.5	200	100	143	287	77.5	135	259	200	65	14
OM3-250/4		265	132.5	200	100	143	357	112.5	170	329	200	65	14
OM3-400		350	175	250	125	218	362	95	170	328	203	65	18
OM3-400/4		350	175	250	125	218	443.5	118.75	213.75	415.5	203	65	18
OM3-630(800)		375	187.5	350	175	241	500	130	240	350	323.5	65	20
OM3-630(800)/4		375	187.5	350	175	241	640	200	310	490	323.5	65	20

Use and Maintenance

The various characteristics of circuit breakers and ancillary equipment from factory setting, the user can not be adjustable in use. circuit breaker handle can be in three positions respectively closing, disconnect, free trip. When the handle is in a free trip position, should be after the slip handle, so that circuit breaker and then buckle, and then closing.

Circuit Breaking Wiring for upward mobility in line, that is, "Line" above, then the power, "Load" then below the load, while not allowed to flip, if we must, under winning it is necessary to reduce short circuit breaking capacity circuit breaker. Generally reduced by 30%.

The user to comply with the custody and use of conditions, from the date of shipment from the manufacturer, not to exceed 18 months, circuit breakers seals intact, the product manufacturing quality problems as a result of the event of damage or can not properly used, manufactures should be free of charge to replace or repair.

Need to continually improve due to product technology, all data should be subject to the latest data to determine, subject to change without notice, This product's copyright and interpret Open Group Holding Ltd overseas.

Use and Maintenance

- 1、Circuit breaker type, name;
- 2、Tripper of the rated current;
- 3、Sub device name, size, combination code;
- 4、Connection: plate before the connection can be omitted. Boards and post-insert, plug-in wiring should explain;
- 5、The numbers.

OM8 Moulded Case Circuit Breaker



Application

1. OM8(NS) Series Moulded Case Circuit Breakers (hereinafter called breaker) is new type product developed by our company, The design of this kind breaker reflects the new current limiting principle and manufacture technology. It is compact in structure, full modular, high breaking, zero flash over and so on characteristics. The breaker of rated insulated voltage 750V is suitable for AC 50HZ, rated working voltage 690V and below, rated working current up to 630A for infrequently switching and starting motor. The breaker is provided with overload short circuit and under voltage protective device can protect the line and power supply equipment from damage.
2. In accordance with the ultimate short circuit breaking capacity (Icu) classified into four types: Type N (standard), Type H (higher), Type L (current limiting).
3. This breaker can be installed in vertical (upright), or horizontal mode, This breaker can be inversed incoming line, i.e. only can 1, 3, 5 connect with power supply line, 2, 4, 6 connect with load terminal.
4. The breaker complies with the following standards: IEC60947-1 and GB/T14048.1 general; IEC60947-2 and GB/T14048.2 low-voltage circuit breaker; IEC60947-4 and GB/T14048.4 contactor and motor starter; IEC60947-5 and GB/T14048.5 Electrical Equipment of Electromechanical Control Circuit;

The Model No. and Meaning

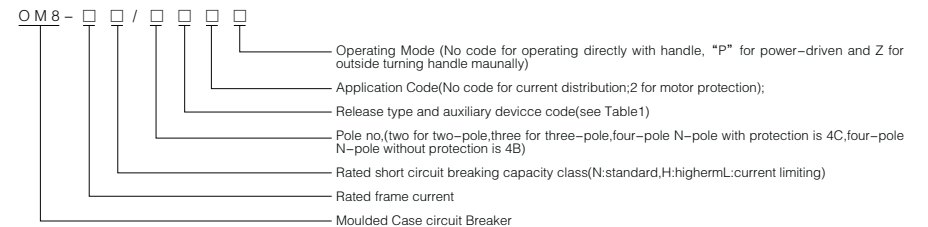

Release type and accessories code See Table 1

Code	Accessories name													
	none	Alarm contact	shunt release	auxiliary contact	Under-voltage release	shunt release +auxiliary contact	two group of auxiliary contact	Under-voltage release +auxiliary contact	shunt release +alarm contact	auxiliary contact +alarm contact	Under-voltage release +alarm contact	shunt release +auxiliary contact +alarm contact	two group of auxiliary contact +alarm contact	Under-voltage release +auxiliary contact +Alarm contact
alarm contact	200	208	210	220	230	240	260	270	218	228	238	248	268	278
instantaneous release	300	308	310	320	330	340	360	370	318	328	338	348	368	378
double release	400	408	410	420	430	440	460	470	418	428	438	448	468	478

Note: there is no 260, 360, 460, 268, 368 and 468 among accessories of OM8-100, 160, 250

OM8 Moulded Case Circuit Breaker

Protective Characteristics

The over-current protective characteristics of the thermodynamic release

See Table 2 for distribution circuit breaker:

Table 2

Rated current	long time delay action characteristic (ambient temp40°C)		Instantaneous action characteristic
	1.05In Cold state Non-action time	1.30In Hot state Action time	
In ≤ 63	≥ 1h	< 1h	10In ± 20%
In > 63	≥ 2h	< 2h	10In ± 20%

See Table 3 for distribution circuit breaker:

Table 3

Rated current	long time delay action characteristic (ambient temp40°C)				Instantaneous action characteristic
	1.0In Cold state Non-action time	1.2In Hot state Action time	1.5In Hot state Action time	7.2In Cold state Non-action time	
In ≤ 400	≥ 2h	< 2h	4min	4s < T ≤ 10s	12In ± 20%

See Table 4 for over-current protective characteristics of intelligent release

Table 4

Adjustable short time delay action characteristic			short time delay characteristic		Instantaneous action characteristic
1.5Ir Action time	6Ir Action time	7.2Ir Action time	Action time		
120~180S	5~7.5S	3.5~5S	≤ 60ms		≥ 11In ± 20%

Main Technical Parameters

Model	Rated frame current Inm(A)	Rated current In(A)	Rated working voltage (V)	Rated limited short-circuit breaking capacity Uj(A)	Rated running short circuit breaking capacity (KA) AC380V	Overall dimension Ics(%Icu)	Overall dimension(mm)			Installation dimension (mm)			Operating performance (time)	
							L	W	H	A	B	Φd	Power-on	Power-off
OM8(NS)-100N	100	25, 40	690	750	25	75%	161	105/140	86	35	125	2-Φ6	1500	8500
OM8(NS)-100H		50, 63			70	75%								
OM8(NS)-100L		80, 100			150	75%								
OM8(NS)-160N	160	125 160	690	750	36	75%	161	105/140	86	35	125	2-Φ6	1000	7000
OM8(NS)-160H					70	75%								
OM8(NS)-160L					150	75%								
OM8(NS)-250N	250	200	690	750	36	75%	161	105/140	86	35	125	2-Φ6	1000	7000
OM8(NS)-250H		225			70	75%								
OM8(NS)-250L		250			150	75%								
OM8(NS)-400N	400	350 400	690	750	45	75%	255	140/185	110	45	200	4-Φ6	1000	4000
OM8(NS)-400H					70	75%								
OM8(NS)-400L					150	75%								
OM8(NS)-630N	630	500 600	690	750	45	75%	255	140/185	110	45	200	4-Φ6	1000	4000
OM8(NS)-630H					70	75%								
OM8(NS)-630L					150	75%								

Overall and installation dimension

- Overall and installation dimension of MO8(NS)-100,160,250(X-X,Y-Y is center pin of breaker) See Fig.1
- Overall and installation dimension of MO8(NS)-400,600(X-X,Y-Y is center pin of breaker) See Fig.2

OM8 Moulded Case Circuit Breaker

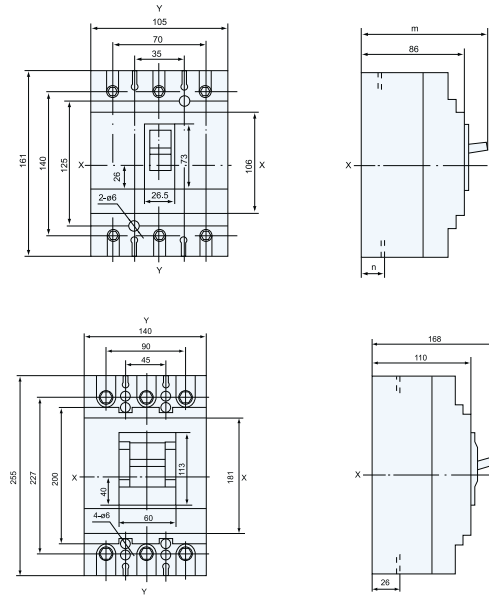

Service and Maintenance

- Each feature and accessory of the breaker has been set by the manufactory. Do not adjust freely when using.
- The handle of breaker has three positions:which is ON(Close up),Off(Break),Middle position(Trip).When the handle at the Middle position(Trip),it should be turn to "off " position,then turn to "On " position again.
- The manufactory will be responsible for exchanging in free charge for the unqualified product within eighteen months froms the delivery date of manufactory,if users follow the regulation and using condition correctly.
- All of the technical parameter is refer to the newest data because the technology needs improved continuously.If there is changed,forgive us for not informing in addition.

OW18 Intelligent Frame-Type-Universal Breaker



Application

OW18(DW45) series intelligent universal low-voltage circuit breakers(here in after called as circuit breaker), suitable for using in the distribution circuit of AC 50HZ, rated voltage up to 660(690V) and below, rated current 400A-630A for distributing electric energy and protecting circuit and power supply equipment from overload, under voltage, short circuit, single grounding and so on dangers. The breaker is provided with intellectualized protective function, selective protection precision that can increase powersupply more reliable and fail to power interrupt. Meanwhile, the breaker is equipped with open type communication interface to meet the demand of control center and auto system. The impulse withstand voltage of the breaker is 8000V at the altitude 2000m(the impulse withstand voltage is as per the different altitude standard, the Max should be less than 12000V). This breaker does not provide intelligent controller and transducer for the purpose of isolator. The sign is -.-.

The breaker is in conformity with GB14048.2 "Low-voltage Switchgear and Control Equipment Low-voltage Circuit Breaker" and IEC60947-2" Low-voltage Switchgear and Control Equipment Circuit Breaker" and standards.

The Model No.and Meanig

Model and Implication

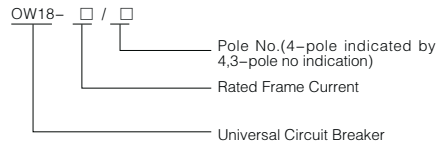

According to the installation mode, it can be classified into:

- a.Fixed type
- b.Drawer type

According to pole number, it can be classified into:three-pole,four-pole;

- a.Motor operation
- b.Manual operation(for corrective maintenance)

Release king

Intelligent controller, under-voltage instantaneous(or time-delay) release,shunt release.

The Performance of the Intelligent Controller

- a. Intelligent controller:type H(for communication), Type M(Common Intelligent type), Type L(Economic type);
- b. With overload long time delay and inverse time limit, timing limit, instantaneous function. User can set by himself to form the needed protective characteristics.
- c. Single grounding protective function;
- d. Display function:Setting current display, action current display, each phase voltage display(the voltage display should be told when ordering);
- e. Alarm Function:Overalarm
- f.Self-checking function:Overheat self-checking, and micro self-checking;
- g.Test Function>Action Characteristics of test controller.

Main Technical Date and Performance

Rated current of the breaker shown Table 1.

Table 1

Inm A Rated frame current	In A Rated current
2000	400、630、800、1000、1250、1600、2000
3200	2000、2500、2900、3200
4000	3200、3600、4000
6300	4000、5000、6000

OW18 Inteugient Frame-Type-Universal Breaker



The rated short circuit breaking capacity and short time withstand current shown as Table2,flashover distance*zero*(i.e.without flashover outside)

Table 2

A Rated frame current	2000	3200	4000	6300
Icu (KA) O-CO Rated ultimate short circuit breaking capacity	400V	80	100	100
	690V	50	65	65
n x Icu(KA)/cos φ Rated short circuit onoff capacity	400V	176/0.2	220/0.2	220/0.2
	690V	105/0.25	143/0.2	143/0.2
Ics(KA) O-CO-CO Rated ultimate short circuit breaking capacity	400V	50	65	65
	690V	40	65	65
Icw(kA) 1s,time delay 0.4s,O-CO Rated short time withstand current	400V	50	65	65/80(MCR)
	690V	40	50	50/65(MCR)
				85/100(MCR)
				65/75(MCR)

Note:The upper and lower incoming line of breaking capacity in the Table is the same.

Overall and Mounding Dimensions

See Fig.1&2 for overall and mounting dimensions of fixed type breaker

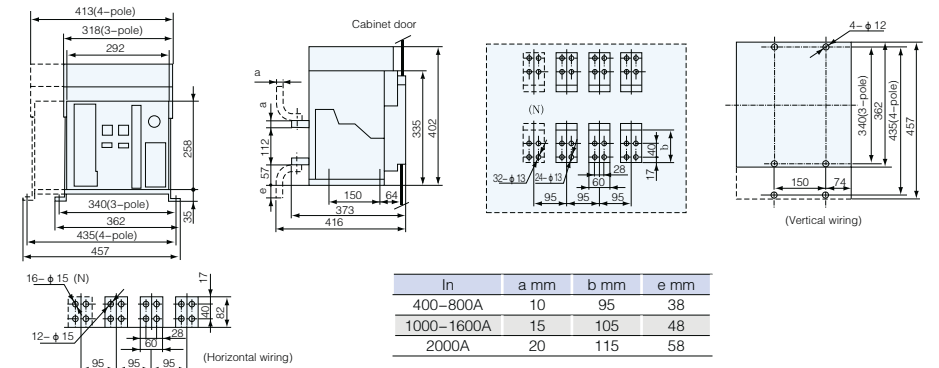

Fig.1 overall and mounting dimensions of fixed type breaker (OW18-2000, 2000/4)

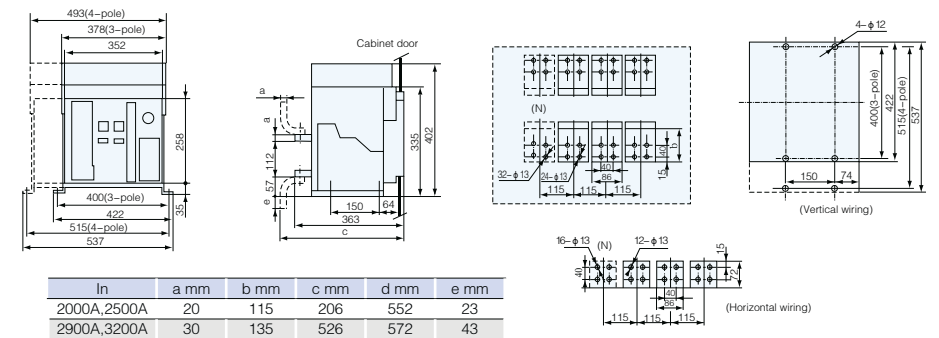

Fig.2 overall and mounting dimensions of fixed type breaker (OW18-3200, 3200/4)

OW18 Intelligent Frame-Type-Universal Breaker

See Fig.3, 4, 5, 6, 7, 8 & 9 for overall and mounting dimensions of drawer type breaker

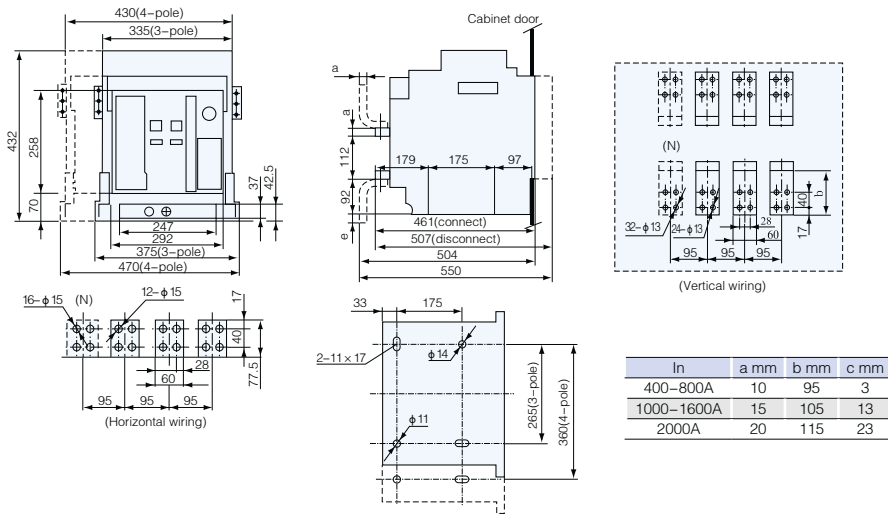

Fig.3 overall and mounting dimensions of drawer type breaker (OW18-2000, 2000/4)

OW18 Intelligent Frame-Type-Universal Breaker

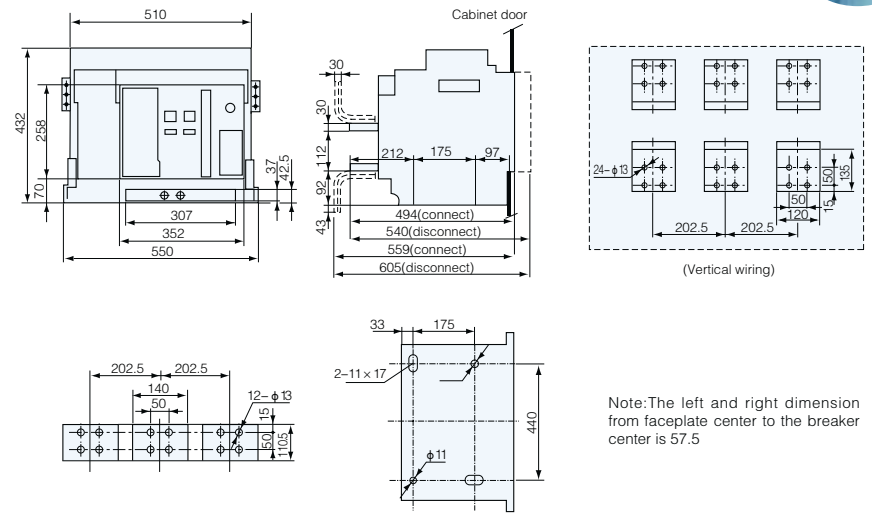

Fig.5 overall and mounting dimensions of drawer type breaker (OW18-4000)

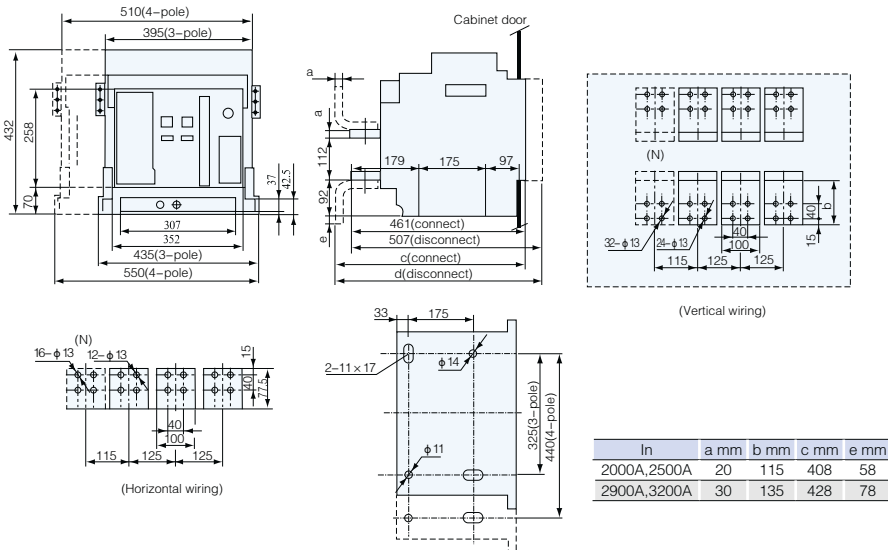

Fig.4 overall and mounting dimensions of drawer type breaker (OW18-3200, 3200/4)

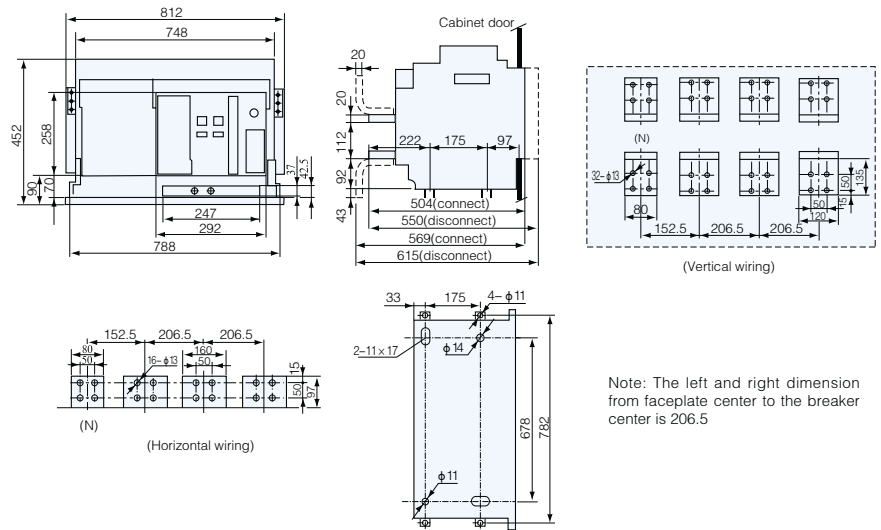

Fig.6 overall and mounting dimensions of drawer type breaker (OW18-4000/4)

OW18 Inteuigent Frame-Type-Universal Breaker

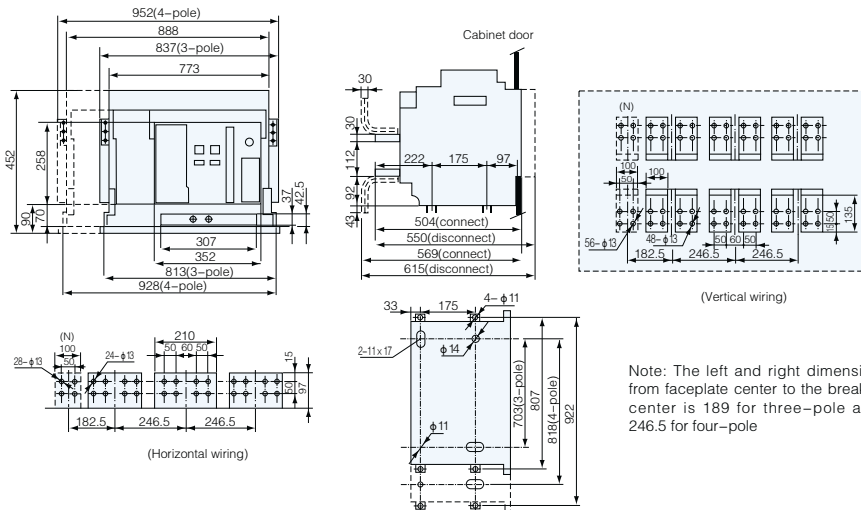

Fig.7 overall and mounting dimensions of drawer type breaker (OW18-6300、6300/4 In=4000、5000)

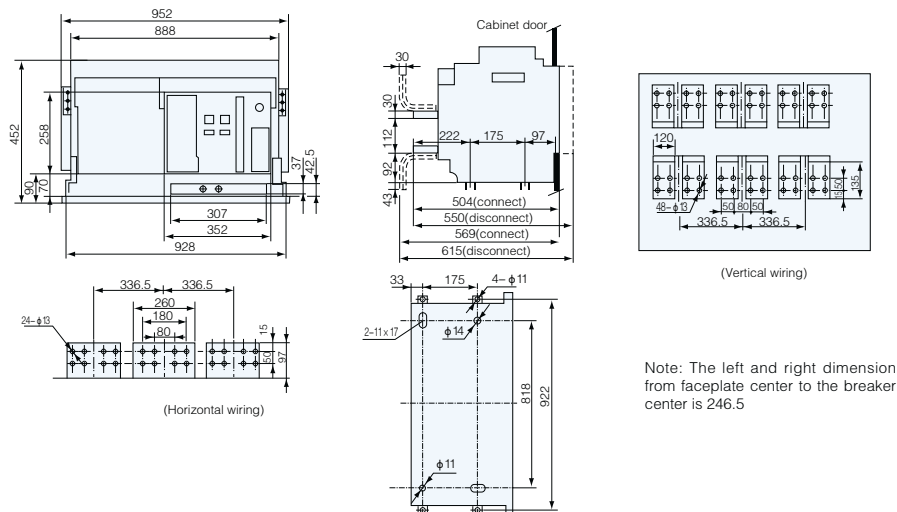

Fig.8 overall and mounting dimensions of drawer type breaker (OW18-6300 In=6300A)

OW18 Inteuigent Frame-Type-Universal Breaker

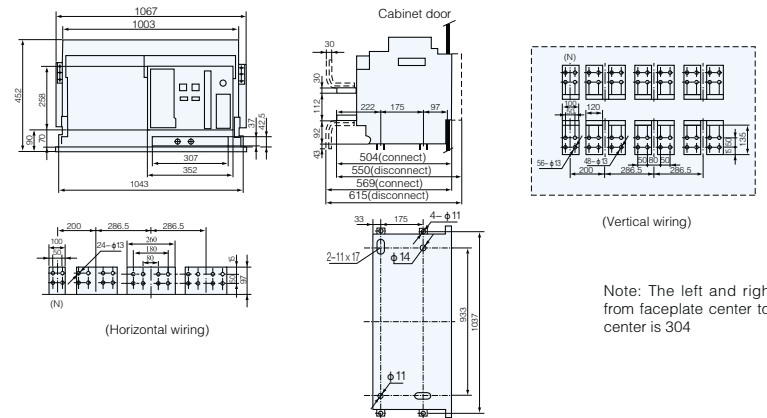
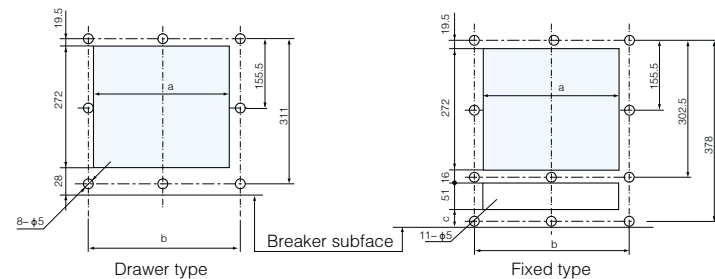

Fig.9 overall and mounting dimensions of drawer type breaker (OW18-6300/4 In=6300A)

See the following Table for user' s connecting copper bar specification and quantity

Rated current	Number of each pole	External copper bar specification	Rated current	Number of each pole	External copper bar specification
630A	40 × 5	2	2900A	100 × 10	3
800A	50 × 5	2	3200A	120 × 10	3
1000A	60 × 5	2	3600A	120 × 10	4
1250A	80 × 5	2	4000A	120 × 10	4
1600A	100 × 5	2	5000A	120 × 10	5
2000A	100 × 5	3	6300A	120 × 10	6
2500A	100 × 5	4			

Doorframe Dimension and Mounting Hole Distance



Inm	a mm	b mm	c mm
2000	306	345	0
3200、4000/3	366	405	0
4000/4	306	345	20
6300	366	405	20

OW18 Intelligent Frame-Type-Universal Breaker

Type M or H Controller

- 1.Reset Key. Pressing the Reset Key to close the breaker once more after tripping. Otherwise,the breaker cannot close.
2. Current(voltage),time display,display current(voltage)or time value.
- 3.*Selection* Key.Each current(voltage) value can be circularly displayed under normal running state. The fault current or time value can be circularly displayed under fault state or fault check state.
- 4.LED Light Indication, can indicate each state and classification.
- 5.*Clear up Light* Key, after setting controller and test fault or before closing breaker should press this Key to make the release be in normal running state.
- 6.*Set*Key. Used for check or set different protective characteristic current or time. Pressing this key can circularly indicate different states.
- 7.*Fault Check* Key. After the controller*clear up light", pressing this key can display and indicate the previous fault state and fault current or time value. The fault curent or time will be circularly checked through pressing* selective" Key.
- 8.*Tripping*,*non-tripping* Key. Used for test function.
- 9.*Store*,*+*,*-* Key. Used for setting current or time.

Ir4—grounding protective current setting value

Ir1—long time—delay current setting value

Ir2—short time—delay current setting value

Ir3—instantaneous current setting value

tG—grounding protetive time setting value

tL—long time —delay time setting value

ts—short time—delay time setting value

