



- LED-Dimmer / Universal dimmer
- DIN-rail mounting 17.5 mm
- For pushbuttons
- Suitable for dimmable LED, incandescent, halogen and fluorescent lamps
- For leading or trailing edge dimming
- Minimum dimming-value adjustable (minimum value for LEDs: 4 W)
- Memoryfunction of the last dimming value
- Master-Slave-function: With the inclusion of further dimmers higher loads can be controlled with one single pushbutton connection (Master)
- Protection against overload, short circuit and overheat

illuminate

switching controlling counting

## Dimmers 872 110 led for DIN-rail mounting

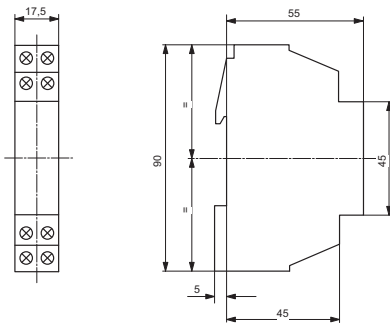

Standard installation

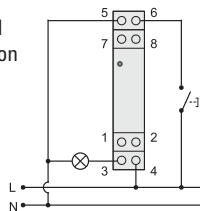

Master/slave installation

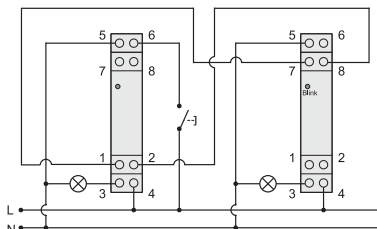

### Technical data

Supply voltage	230 V, 50 Hz		
Power consumption	3 VA		
Mounting	35 mm DIN-rail		
Permitted ambient temperature	0°...+40°C		
Type of protection	IP 20 to DIN EN 60529		
Type of lamps	dimmable LED lamps, incandescent lamps, halogen lamps and fluorescent lamps		
Glow lamp load	max. 3 mA		
Types of load	<b>R, L, C</b>	<b>CFL</b>	<b>LED</b>
230 V~ Incandescent lamps (R)	15–400 W	—	—
230 V~ HV-Halogen lamps (R)	15–400 W	—	—
Ferromagnetic transformers for LV-halogen lamps (L)	20–250 W	—	—
Electronic transformers for LV-halogen lamps (L) Leading Edge	15–400 W	—	—
Electronic transformers for LV-halogen lamps (C) Trailing Edge	15–400 W	—	—
Dimmable compact fluorescent lamps	—	20–200 W	—
Dimmable 230 V~ LED lamps (leading edge dimming)	—	—	4–100 W
Dimmable 230 V~ LED lamps (trailing edge dimming)	—	—	4–100 W
Dimmable 12 V~ LED lamps (trailing edge dimming) with electronic transformer, type C	—	—	1 lamp per transformer / max. 300 W (e.g. 6 transformer à 50 W)

Order number	Version
paladin 872 110 led	for DIN-rail mounting
▼ Housing colour	